

BRT2000 SERIES

MERIT SERIES B-VENT GAS FIREPLACES

Superior[™]
FIREPLACES

Our name is our promise.

TRADITIONAL

The BRT2000 Series, offered in three distinct models BRT20/23/25, provides excellent value without compromise on quality or design. These b-vent radiant smooth-faced designs offer an array of standard features that include a single/dual tube burner and detailed ceramic fiber logs to provide continuous ambiance without additional heat to the room.



FEATURED BRT2532 with White Stacked Refractory Panels and Split Oak Log Set

EXCLUSIVE FEATURES

- ✦ Available in 29" radiant smooth-faced models
- ✦ BRT20 - Single tube burner (15,000 BTU) uses 4" b-vent
- ✦ BRT23/25 - Dual tube burner (25,000 BTU) uses 5" b-vent
- ✦ Millivolt (Remote-ready) or electronic ignition
- ✦ Yellow flames with ember bed
- ✦ Detailed ceramic fiber "split oak" log set with log grate
- ✦ BRT20/23 - Black painted interior with white stacked hearth
- ✦ BRT25 - White stacked refractory panel interior (sides, back and hearth)
- ✦ Includes mesh fire screens
- ✦ Durable textured powder coat finish
- ✦ Optional outside air kit for increased performance
- ✦ Optional remote controls available for all models
- ✦ Dual access pre-wired electrical J-box
- ✦ 20 year limited warranty



FEATURED BRT2532 with White Stacked Refractory Panels and Split Oak Log Set

INTERIOR PANEL OPTIONS

(Required)

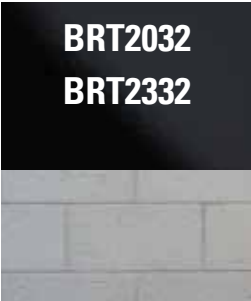

Black Interior with White Stacked Hearth

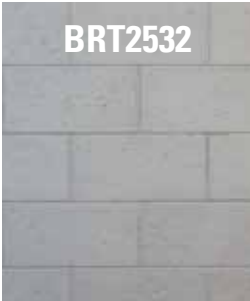

White Stacked Panels (Back, sides and hearth)

EXTERIOR OPTIONS

(Optional)

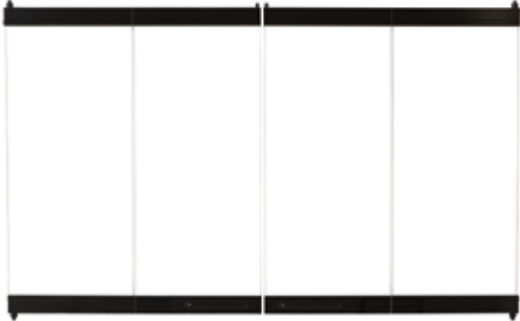

Bi-Fold Glass Doors or Fixed Glass Doors



Black



Brushed Brass



Platinum

FLAT WALL FRAMING SPECIFICATIONS

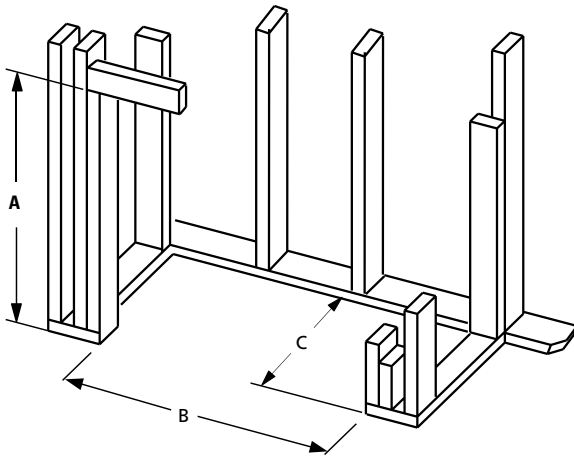

	BRT2032	BRT2332	BRT2532
A	36-5/8"	36-5/8"	36-5/8"
B	34-3/4"	34-3/4"	34-3/4"
C	16-1/8"	16-1/8"	16-1/8"

CORNER FRAMING SPECIFICATIONS

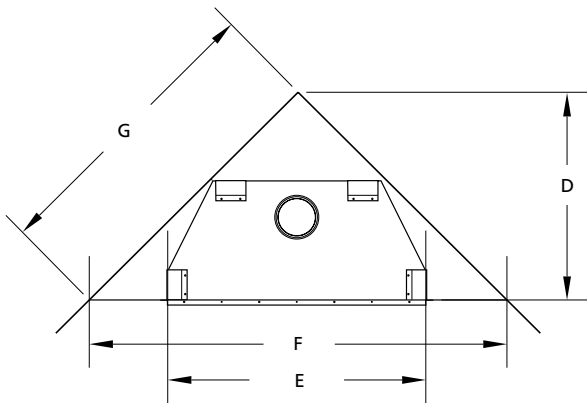

	BRT2032	BRT2332	BRT2532
D	32-3/4"	32-3/4"	32-3/4"
E	55-5/8"	55-5/8"	55-5/8"
F	34-1/2"	34-1/2"	34-1/2"
G	39-3/8"	39-3/8"	39-3/8"

On the cover: BRT2032 with Black Interior and Aged Oak Log Set

IMPORTANT NOTES:

As with any fireplace, this appliance is extremely hot during operation. Read and understand all operating instructions before using this appliance. For further information, consult your dealer.

Local conditions, such as elevation, wind, vent configuration and choice of fuel will affect overall appearance of the fire and heating performance. Performance can also vary with home design and insulation, climate, condition and type of fuel used, appliance location, burn rate, accessories chosen, chimney installation and how the appliance is operated.

Diagrams, illustrations and photographs are not to scale—consult installation instructions. Product designs, materials, dimensions, specifications, colors and prices are subject to change or discontinuance without notice.

APPLIANCE SPECIFICATIONS

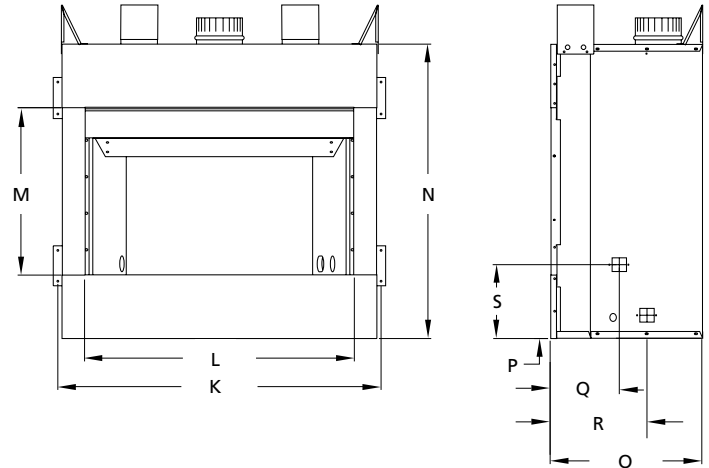
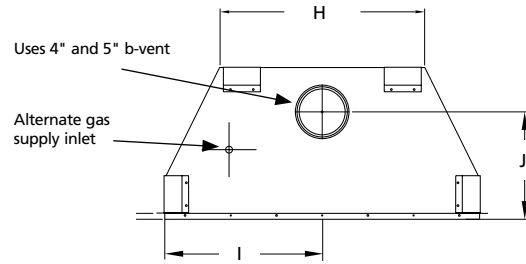

	BRT2032	BRT2332	BRT2532
H	22-3/8"	22-3/8"	22-3/8"
I	17-1/4"	17-1/4"	17-1/4"
J	11-3/4"	11-3/4"	11-3/4"
K	35-3/8"	35-3/8"	35-3/8"
L	29-1/2"	29-1/2"	29-1/2"
M	18-1/4"	18-1/4"	18-1/4"
N	32-1/4"	32-1/4"	32-1/4"
O	16-3/4"	16-3/4"	16-3/4"
P	2-1/2"	2-1/2"	2-1/2"
Q	7-5/8"	7-5/8"	7-5/8"
R	10-5/8"	10-5/8"	10-5/8"
S	8-1/4"	8-1/4"	8-1/4"

FIREPLACE BTU OPERATING INPUT

MODEL	FUEL	BTU/HR
BRT2032	NG	15,000
BRT2332	NG	25,000
BRT2532	NG	25,000



© 2015 Innovative Hearth Products

785380M 06/15

Visit us online



SuperiorFireplaces.us.com

