



www.Source1Parts.com

H2RD SERIES, 13 SEER X3 AIR CONDITIONER (STYLE A)

HVAC SERVICE PARTS

Supersedes:035-20810-001 Rev. E (0706)

035-20810-001 Rev. F (0906)

1 of 4

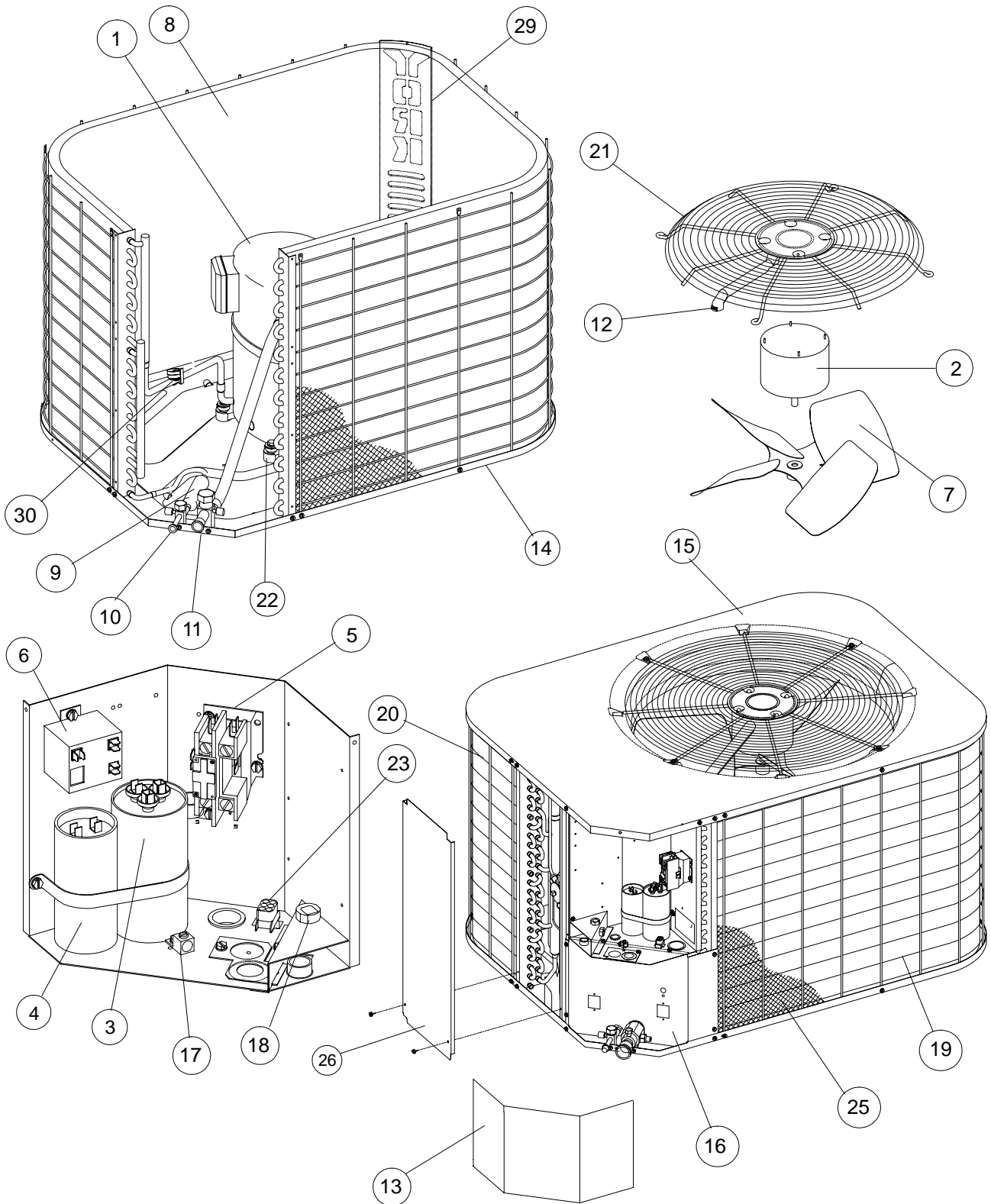

ITEM	DESCRIPTION	H2RD018S06A	H2RD024S06A	H2RD030S06A
1	Compressor, Hermetic	015-03848-001	015-03835-001	015-03806-001
1A*	Compressor Plug Harness	025-31883-000	025-31883-000	025-31884-000
2	Motor, Direct Drive Fan	024-35328-000	024-35328-000	024-27596-000
3	Capacitor, Run (35/5) [RC]	024-23998-000	024-23998-000	---
	Capacitor, Run (30/5) [RC]	---	---	024-24778-000
4	Capacitor, Start	---	---	---
5	Contact, Electrical (30 Amp) [M]	024-27531-000	024-27531-000	024-27531-000
6	Relay, Start	---	---	---
7	Blade, Fan (18")	026-34754-000	026-34754-000	---
	Blade, Fan (22")	---	---	026-34593-000
8	Coil, Condenser	373-23816-001	373-19800-004	373-23816-003
9	Drier, Filter	029-22156-000	029-22156-000	029-22156-000
10	Valve, Liquid (3/8")	025-31899-000	025-31899-000	025-31899-000
11	Valve, Suction (3/4")	025-31900-000	025-31900-000	025-31900-000
12	Wireway	028-13215-000	028-13216-001	028-13216-001
13	Cover, Electrical Box	073-20018-001	073-20018-001	073-20018-001
14	Pan, Base	073-20045-001	073-20045-001	073-20004-801
15	Panel, Top	073-20011-001	073-20011-001	073-20042-801
16	Plate, Blockoff	073-23819-001	073-20002-801	073-20002-801
17	Lug, Ground	025-21798-000	025-21798-000	025-21798-000
18	Relief, Strain	025-09687-000	025-09687-000	025-09687-000
19	Guard, Coil (1 Pair)	373-23817-001	373-23817-002	373-23715-008
	Guard, Coil (1 Req'd)	---	---	---
20	Guard, Coil (1 Req'd)	---	---	---
21	Guard, Fan	026-35511-118	026-35511-118	026-35511-122
22	Mount, Cushion (4 Req'd)	9435-1081	9435-1081	9435-1081
23	Connector, 6 Pos Cap	025-33306-006	025-33306-006	025-33306-006
24*	Diagram, Wiring	035-15861-501	035-15861-501	035-15861-501
25	Coil Guard, Plastic Mesh	028-15460-000	028-15461-000	028-14728-000
26	Panel, Filler	---	---	---
27*	Harness, Wiring	373-20055-004	373-20055-004	373-20055-004
28*	Kit, Motor Mounting (Acorn Nuts)	363-90117-700	363-90117-700	363-90117-700
29	Post, Corner	073-23818-001	073-20012-004	073-20012-004
30*	Check Valve w/Muffler	022-09077-000	022-09077-000	022-09077-000

<

NOTE: *Not Shown

New replacement parts shown in **bold** face type at the first printing of parts list dated 9/06.

Major components and suggested stocking items are shown with shaded item number.

"<" Across from row indicates a change in that row.

--- Not applicable to specified model.



ITEM	DESCRIPTION	H2RD036S06A	H2RD042S06A	H2RD048S06A	H2RD060S06A
1	Compressor, Hermetic	015-03807-001	015-03784-001	015-03710-004	015-03679-004
1A*	Compressor Plug Harness	025-31884-000	025-31884-000	025-31884-000	025-31884-000
2	Motor, Direct Drive Fan	024-27596-000	024-27596-000	024-27596-000	024-27596-000
3	Capacitor, Run (35/5) [RC]	---	024-23998-000	---	---
	Capacitor, Run (40/5) [RC]	024-25893-000			
	Capacitor, Run (60/5) [RC]	---	---	024-25033-000	024-25033-000
4	Capacitor, Start	---	024-25215-000	---	---
5	Contact, Electrical (30 Amp) [M]	024-27531-000	024-27531-000	024-27531-000	024-27531-000
6	Relay, Start	---	024-25053-000	---	---
7	Blade, Fan (22")	026-34094-000	026-34094-000	---	---
	Blade, Fan (24")	---	---	026-42195-000	026-42195-000
8	Coil, Condenser	373-23782-001	373-23782-002	373-23782-003	373-23816-004
9	Drier, Filter	029-22156-000	029-22157-000	026-34095-000	026-34095-000
10	Valve, Liquid (3/8")	025-31899-000	025-31899-000	025-31899-000	025-31899-000
11	Valve, Suction (7/8")	025-31901-000	025-31901-000	025-31901-000	025-31901-000
12	Wireway	028-13216-001	028-13216-001	028-13297-000	028-13297-000
13	Cover, Electrical Box	073-20018-001	073-20018-001	073-20018-001	073-20018-001
14	Pan, Base	073-20004-801	073-20004-801	073-19001-500	073-19001-500
15	Panel, Top	073-20042-801	073-20042-801	073-23757-001	073-23757-001
16	Plate, Blockoff	073-20002-801	073-20002-804	073-23791-002	073-20002-804
17	Lug, Ground	025-21798-000	025-21798-000	025-21798-000	025-21798-000
18	Relief, Strain	025-09687-000	025-09687-000	025-09687-000	025-09687-000
19	Guard, Coil (1 Pair)	373-23715-008	373-23714-009	---	---
	Guard, Coil (1 Req'd)	---	---	373-23760-003	373-23760-008
20	Guard, Coil (1 Req'd)	---	---	373-23760-004	373-23760-009
21	Guard, Fan	026-35511-122	026-35511-122	026-35511-124	026-35511-124
22	Mount, Cushion (4 Req'd)	9435-1081	9435-1081	028-12355-000	028-10190-000
23	Connector, 6 Pos Cap	025-33306-006	---	---	---
24*	Diagram, Wiring	035-15861-501	035-15861-501	035-15861-501	035-15861-501
25	Coil Guard, Plastic Mesh	028-14728-000	028-14733-000	028-15243-000	028-14734-000
26	Panel, Filler	---	---	073-23789-001	073-23758-002
27*	Harness, Wiring	373-20055-004	373-20055-004	373-20055-004	373-20055-004
28*	Kit, Motor Mounting (Acorn Nuts)	363-90117-700	363-90117-700	363-90117-700	363-90117-700
29	Post, Corner	073-20012-004	073-20012-007	073-23788-002	073-20012-007
30*	Check Valve w/Muffler	022-09077-000	---	---	---
	Muffler	---	025-39847-000	---	---

NOTE: *Not Shown

New replacement parts shown in **bold** face type at the first printing of parts list dated 9/06.

Major components and suggested stocking items are shown with shaded item number.

"<" Across from row indicates a change in that row.

--- Not applicable to specified model.



TO ORDER AUTHORIZED FACTORY REPLACEMENT PARTS - Contact your Source1 HVAC Parts Distributor or visit our website at www.Source1Parts.com for a Distributor and Dealer listing.