



www.Source1Parts.com

HVAC SERVICE PARTS

# DRHQ SERIES - 12 SEER - X3 SPLIT (QC) HEAT PUMP

Supersedes:035-16323-003 Rev. D (0602)

035-16323-003 Rev. E (0104)

1 of 4

## MODELS

- DRHQ0241BD
- DRHQ0301BD
- DRHQ0361BD
- DRHQ0421CD
- DRHQ0481BE

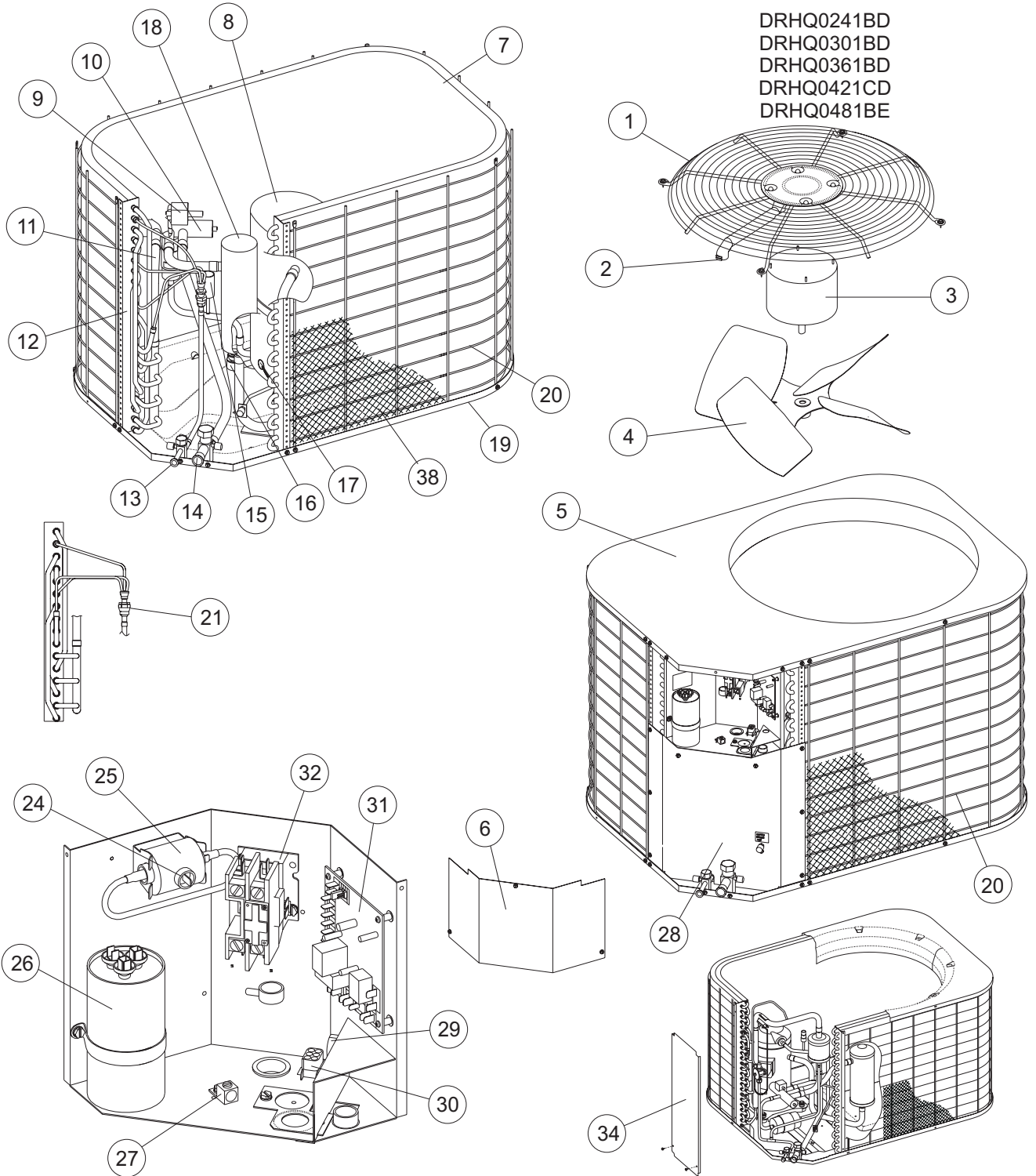

048 ONLY

**Models 24, 30, and 36**

ITEM	DESCRIPTION	DRHQ0241BD	DRHQ0301BD	DRHQ0361BD
1	Fan Guard	026-35511-022	026-35511-022	026-35511-022
2	Wireway	028-13216-000	028-13216-000	028-13216-000
3	Fan Motor	024-27596-000	024-27596-000	024-27596-000
4	Fan Blade 22" Diameter	026-34593-000	026-34593-000	026-34593-000
5	Top	2260-1021/A	2260-1021/A	2260-1021/A
6	Control Box Cover	2218-1151/A	2218-1151/A	2218-1151/A
7	Outdoor Coil Assembly	373-19800-014	373-19800-014	373-19800-015
8	Compressor	015-02748-004	015-02750-004	015-02753-004
9	Solenoid Coil	1456-9761	1456-9761	1456-9761
10	Reversing Valve	025-31922-000	025-31922-000	025-31922-000
11	Filter Drier	1458-0011	1458-0011	6536-3341
12	Coil Sensor	025-31994-000	025-31994-000	025-31994-000
13	Base Valve 3/8" (Liquid)	3924-3021	3924-3021	3924-3021
14	Base Valve 3/4" (Suction) Base Valve 7/8" (Suction)	3924-3051 ---	3924-3051 ---	--- 3948-3051
15	High Pressure Switch	025-33305-048	025-33305-048	025-33305-048
16	Compressor Mount (Pkg. of 4)	9435-1081	9435-1081	9435-1081
17	Crankcase Heater	1450-9511	1450-9511	1450-9511
18	Accumulator Tank	026-34089-000	026-34089-000	026-34090-000
19	Base Pan	2260-1011	2260-1011	2260-1011
20	Coil Guard	<b>373-20091-010</b>	<b>373-20091-010</b>	<b>373-20091-012</b>
21	Distributor (.040 Orifice) Distributor (.048 Orifice) Distributor (.050 Orifice)	022-09010-440 --- ---	--- 022-09010-448 ---	--- --- 022-09010-550
22				
23				
24	Limit Switch (Heater)	025-31924-000	---	025-31924-000
25	Solid State Start Device	---	024-20867-002	---
26	Dual Capacitor (30/5 MFD) Dual Capacitor (35/5 MFD) Dual Capacitor (40/5 MFD)	024-24778-000 --- ---	--- 024-23998-000 ---	--- --- 024-25893-000
27	Ground Lug	1216-229	1216-229	1216-229
28	Blockoff Plate	2248-1081/B	2248-1081/B	3948-1081/B
29	Strain Relief	1216-243	1216-243	1216-243
30	6 Position Plug	025-33306-006	025-33306-006	025-33306-006
31	Defrost Control Board	031-01954-000	031-01954-000	031-01954-000
32	Contactora (30 amp)	024-27531-000	024-27531-000	024-27531-000
33	Fan Cut-Out Switch	---	---	025-35348-000
34	Filler Panel	---	---	---
35*	Wiring Diagram	035-15860-003	035-15860-003	035-15860-003
36*	Compressor Harness	025-31884-000	025-31884-000	025-31884-000
37*	Kit, Motor Mounting (Acorn Nuts)	363-90117-700	363-90117-700	363-90117-700
38	Mesh, Coil Guard	028-14728-000	028-14728-000	028-14731-000
39*	Fastener, Push-in (4 Req'd) Fastener, Push-in (6 Req'd)	021-18381-000 ---	021-18381-000 ---	--- 021-18381-000

**NOTE:** \*Not Shown  
New replacement parts shown in **bold** face type at the first printing of parts list dated 1/04.  
Major components and suggested stocking items are shown with shaded item number.   
"←" Across from row indicates a change in that row.  
--- Not applicable to specified model.

**Models 42 and 48**

ITEM	DESCRIPTION	DRHQ0421CD	DRHQ0481BE
1	Fan Guard	026-35511-022	026-35511-024
2	Wireway	028-13216-000	028-13297-000
3	Fan Motor	024-27596-000	024-27596-000
4	Fan Blade 22" Diameter Fan Blade 24" Diameter	026-34593-000 ---	--- 026-35437-000
5	Top	2260-1021/A	073-19002-101
6	Control Box Cover	2218-1151/A	073-19009-101
7	Outdoor Coil Assembly	373-19800-015	373-19027-480
8	Compressor	015-02690-004	015-02902-004
9	Solenoid Coil	1456-9761	1456-9761
10	Reversing Valve	025-31930-000	025-31930-000
11	Filter Drier	6536-3341	026-34506-000
12	Coil Sensor	025-31994-000	025-31994-000
13	Base Valve 3/8" (Liquid)	3924-3021	3924-3021
14	Base Valve 7/8" (Suction)	3948-3051	3948-3051
15	High Pressure Switch	025-33305-048	025-33305-048
16	Compressor, Mount (4 Req'd)	028-12355-000	028-12355-000
17	Crankcase Heater	---	---
18	Accumulator Tank	026-34090-000	026-25573-007
19	Base Pan	2260-1011	073-19001-000
20	Coil Guard	<b>373-20091-012</b>	<b>373-20091-022</b>
21	Distributor (.057 Orifice) Distributor (.065 Orifice)	022-09010-557 ---	--- 022-09010-665
22			
23			
24	Limit Switch (Heater)	---	---
25	Solid State Start Device	---	---
26	Dual Capacitor (55/5 MFD) Dual Capacitor (50/5 MFD)	024-25049-000 ----	--- 024-25896-000
27	Ground Lug	1216-229	1216-229
28	Blockoff Plate	3948-1081/B	073-19008-130
29	Strain Relief	1216-243	1216-243
30	6 Position Plug	025-33306-006	025-33306-006
31	Defrost Control Board	031-01954-000	031-01954-000
32	Contacto (30 amp)	024-27531-000	024-27531-000
33	Fan Cut-Off Switch	025-35348-000	025-35348-000
34	Filler Panel	---	073-19007-130
35*	Wiring Diagram	035-15860-003	035-15860-003
36*	Compressor Harness	025-31884-000	025-31884-000
37*	Kit, Motor Mounting (Acorn Nuts)	363-90117-700	363-90117-700
38	Mesh, Coil Guard	028-14731-000	028-14732-000
39*	Fastener, Push-in (6 Req'd)	021-18381-000	021-18381-000

**NOTE:** \*Not ShownNew replacement parts shown in **bold** face type at the first printing of parts list dated 1/04.

Major components and suggested stocking items are shown with shaded item number.

"←" Across from row indicates a change in that row.

--- Not applicable to specified model.

## NOTES

**TO ORDER AUTHORIZED FACTORY REPLACEMENT PARTS** - Contact your Source1 HVAC Parts Distributor or visit our website at [www.Source1Parts.com](http://www.Source1Parts.com) for a Distributor and Dealer listing.