

REPAIR PARTS

CPLE (10 SEER) Remote Condensing Unit

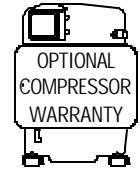

- CPLE18-1
- CPLE18-1A
- CPLE24-1
- CPLE24-1A
- CPLE30-1
- CPLE36-1
- CPLE42-1
- CPLE48-1
- CPLE48-3
- CPLE60-1
- CPLE60-3

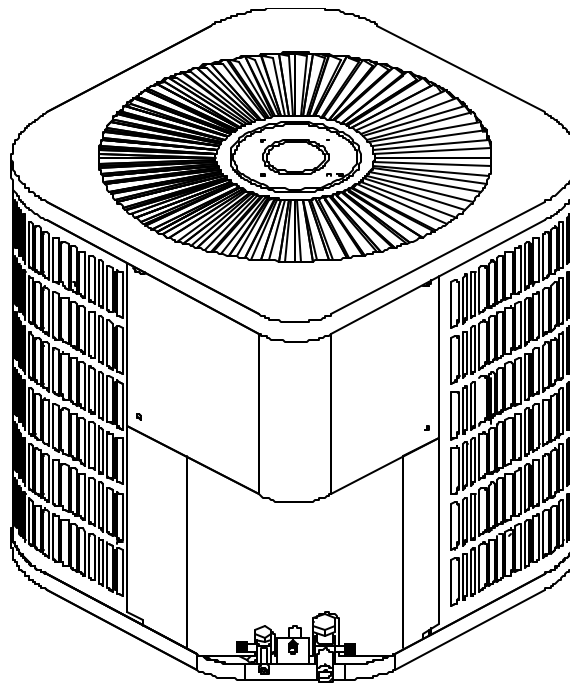

This manual is to be used by qualified technicians only.

Made in the USA by:
Goodman Manufacturing Company
2550 North Loop West, Suite 400
Houston Texas 77092

RP278 B
November 2002

This manual replaces RP278A.

Important Information

Goodman is not responsible for personal injury or property damage resulting from improper service. Review all service information before beginning repairs.

Warranty service must be performed by an authorized technician, using authorized factory parts. If service is required after the warranty expires, Goodman also recommends contacting an authorized technician and using authorized factory parts.

For assistance within the U.S.A. contact:

Consumer Affairs Department
Goodman Company LP
7401 Security Way
Houston, Texas 77040
877-254-4729-Telephone
713-863-2382-Facsimile

For assistance outside the U.S.A. contact:

International Division
Goodman Company LP
7401 Security Way
Houston, Texas 77040
713-861-2500-Telephone
713-863-2382-Facsimile

Index

Functional Parts List	5
Illustration and Parts	6 - 9

Views shown are for parts illustrations only, not servicing procedures.

Revision B changes the louver used on CLPE18-1A.

Text Codes:

AR - As Required

NA - Not Available

NS - Not Shown

00000000 - See Note

QTY - Quantity Example (QTY 3) (If Quantity not shown, Quantity = 1)

M - Model Example (M1) (If M Code not shown, then part is used on all Models)

Expanded Model Nomenclature:

Example
M1 - Model#1
M2 - Model#2
M3 - Model#3

This page left blank intentionally.

Functional Parts

Part

No: Description:

B94578700	CAPACITOR, DUAL-SECTION, 30 MFD, 5 MFD, 370 VAC (M1, M2, M3, M4)
B94575300	CAPACITOR, DUAL-SECTION, 35 MFD, 5 MFD, 370 VAC (M5)
B94575400	CAPACITOR, DUAL-SECTION, 35 MFD, 5 MFD, 440 VAC (M7)
B94575600	CAPACITOR, DUAL-SECTION, 40 MFD, 5 MFD, 440 VAC (M8)
B94577200	CAPACITOR, DUAL-SECTION, 45 MFD, 5 MFD, 370 VAC (M6)
B94577500	CAPACITOR, DUAL-SECTION, 60 MFD, 5 MFD, 370 VAC (M10)
B945650	CAPACITOR, RUN, 5 MFD, 370 VAC (M9, M11)
1260522NP	COIL, CONDENSER, (FORMED) (22.5" X 58") (M1, M2)
1260625NP	COIL, CONDENSER, (FORMED) (25" X 82") (M6)
1260530NP	COIL, CONDENSER, (FORMED) (30" X 58") (M3, M4, M5)
1260630NP	COIL, CONDENSER, (FORMED) (30" X 82") (M7)
1260632NP	COIL, CONDENSER, (FORMED) (32.5" X 82") (M8, M9, M10, M11)
B9266353	COMPRESSOR, 200/230-60-3, COPELAND #ZR57KC-TF5-230 (M11)
B9266218A	COMPRESSOR, 208/230-60-1, BRISTOL #H23A383ABCA (M7)
B9266201A	COMPRESSOR, 208/230-60-1, BRISTOL #H23A423ABCA (M8)
B9266812A	COMPRESSOR, 208/230-60-1, BRISTOL #H23B24SABCA (M3)
B9266600A	COMPRESSOR, 208/230-60-1, BRISTOL #H25B17QABCA (M1, M2)
B9266834A	COMPRESSOR, 208/230-60-1, BRISTOL #H29B22UABCA (M4)
B9266843A	COMPRESSOR, 208/230-60-1, BRISTOL #H29B28UABCA (M5)
B9266835A	COMPRESSOR, 208/230-60-1, BRISTOL #H29B35UABCA (M6)
B9266355	COMPRESSOR, 208/230-60-1, COPELAND #ZR57KC-PFV-250 (M10)
B9266204A	COMPRESSOR, 208/230-60-3, BRISTOL #H23A423DBLA (M9)
B1360321	CONTACTOR, 24 VOLT COIL, 125 LRA, 1 POLE, 25 AMP, (M1, M2, M3, M4, M5, M6, M7)
B1360324	CONTACTOR, 24 VOLT COIL, 150 LRA, 1 POLE, 30 AMP (M8)
B1360315	CONTACTOR, 24 VOLT COIL, 150 LRA, 3 POLE, 25 AMP, (M9, M11)
B1360305	CONTACTOR, 24 VOLT COIL, 200 LRA, 2 POLE, 40 AMP, (M10)
B13400255	MOTOR CONDENSER FAN, 208/230-60-1, 1 SPEED PSC, 1075 RPM, 1/4HP (M7)
B13400247	MOTOR, CONDENSER, FAN, 208/230-60-1, 1 SPEED, PSC, 1075 RPM, 1/4 HP (M6, M8, M9, M10, M11)
B13400251	MOTOR, CONDENSER, FAN, 208/230-60-1, 1 SPEED, PSC, 1075 RPM, 1/6 HP (M1, M2, M3, M4, M5)

SPECIAL PARTS

IO-103	INSTALLATION & OWNERS MANUAL
SS-334	SPECIFICATION SHEET
B260S8291	SPRAY PAINT (HIGH GLOSS BAHAMA BEIGE)

Expanded Model Nomenclature

M1 - CPLE18-1
M2 - CPLE18-1A
M3 - CPLE24-1
M4 - CPLE24-1A
M5 - CPLE30-1
M6 - CPLE36-1
M7 - CPLE42-1
M8 - CPLE42-1
M9 - CPLE48-3
M10 - CPLE60-1
M11 - CPLE60-3

Louvered Chassis & Control Box

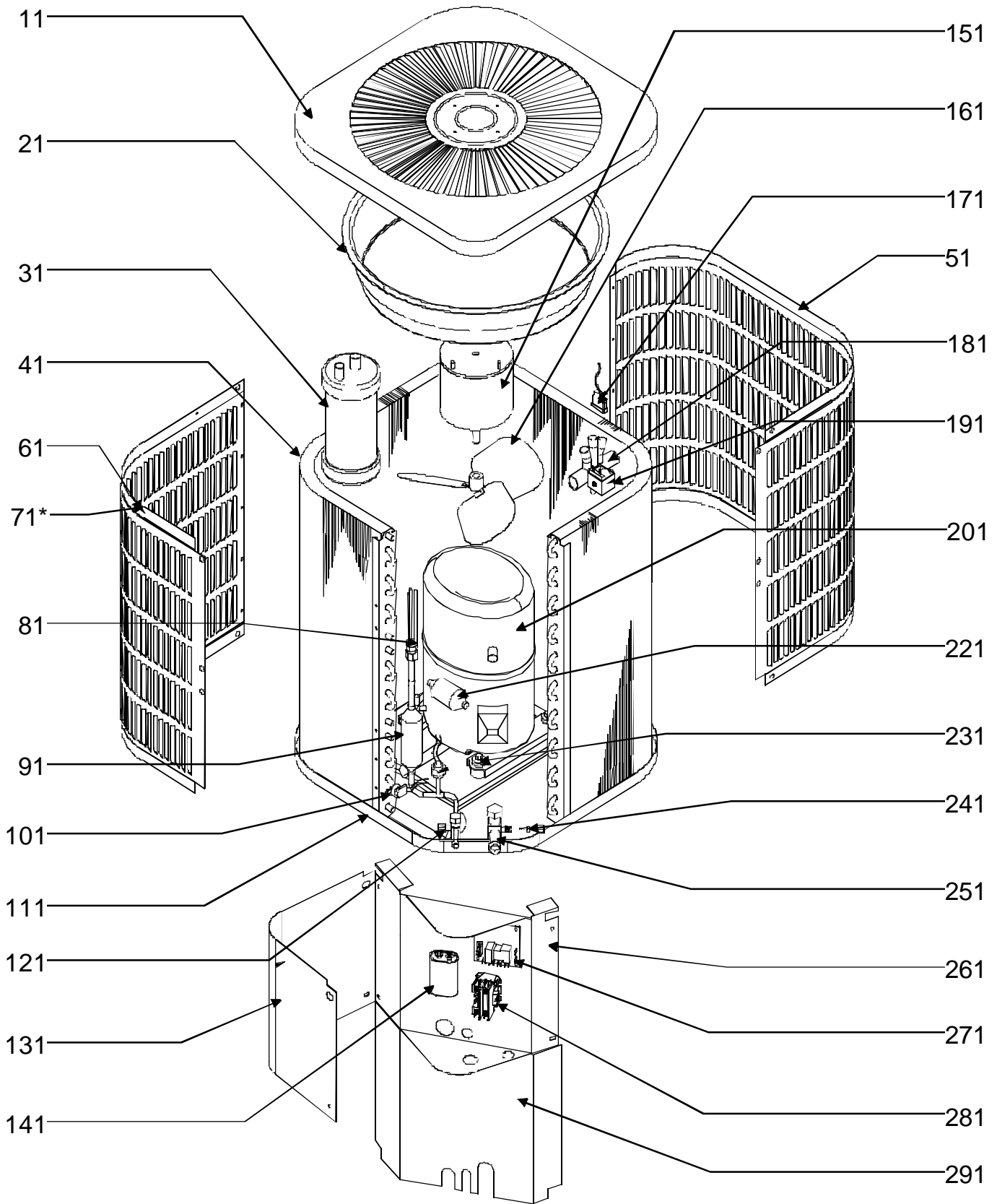

Louvered Chassis & Control Box

Ref. Part No:	Ref. Part No:	Description:	Description:
<i>Image 1:</i>			
11	1759574	PANEL, TOP (LOUVERED) (M2)	231 B1339530 GROMMET, COMPRESSOR (M1, M2, M3, M4, M5)
11	1779405P	PANEL, TOP (LOUVERED) (M1, M2, M3, M4, M5)	241 B1787000 CORE, VALVE (QTY 2)
31	B1226206	ACCUMULATOR (3/4 O.D.) (M5)	251 B1282566 VALVE, BASE, SUCTION LINE, 3/4" SWEAT X 3/4" SWEAT (M1, M2, M3, M4, M5)
31	B1226205	ACCUMULATOR (5/8 O.D.) (M1, M2, M3, M4)	261 1787623 BOX, CONTROL
41	1260522NP	COIL, CONDENSER, (FORMED) (22.5" X 58") (M1, M2)	271 B1226008 DEFROST CONTROL W/RELAY
41	1260530NP	COIL, CONDENSER, (FORMED) (30" X 58") (M3, M4, M5)	281 B1360321 CONTACTOR, 24 VOLT COIL, 125 LRA, 1 POLE, 25 AMP, (M1, M2, M3, M4, M5)
51	1259550P	LOUVER PANEL H/PIN SIDE (M1)	291 1787706P PANEL, ACCESS, (22.5") (M1, M2)
51	1259553P	LOUVER PANEL H/PIN SIDE (M3, M4, M5)	291 1787709P PANEL, ACCESS, (30.0") (M3, M4, M5)
61	1259555P	LOUVER PANEL RETURN SIDE (M1)	
61	1259558P	LOUVER PANEL RETURN SIDE (M3, M4, M5)	
71	1259574	LOUVER SIDE PANEL (M2) * SINGLE PIECE LOUVER	
81	B1314341	FLOWRATER W/COPPER (M1, M2)	
81	B2114447	FLOWRATER W/COPPER (M3, M4)	
81	B2114455	FLOWRATER W/COPPER (M5)	
91	R1219204	DRIER, BI-FLOW. 3/8" x 3/8"	
91	R1370803	THERMOSTAT, DEFROST	
101	1787211P	PAN, BOTTOM (SMALL) (M1, M2, M3, M4, M5)	
121	R1282571	VALVE, BASE, LIQUID LINE, 3/8" SWEAT X 5/16" SWEAT	
131	1787624P	CONTROL BOX COVER	
141	B94578700	CAPACITOR, DUAL-SECTION, 30 MFD, 5 MFD, 370 VAC (M1, M2, M3, M4)	
141	B94575300	CAPACITOR, DUAL-SECTION, 35 MFD, 5 MFD, 370 VAC (M5)	
151	B13400251	MOTOR, CONDENSER, FAN, 208/230-60-1, 1 SPEED, PSC, 1075 RPM, 1/6 HP (M1, M2, M3, M4, M5)	
161	B1086756	FAN, CONDENSER, 3 BLADE, 18" DIA, (M1, M2, M3, M4, M5)	
171	B1225020	SOLENOID COIL CORD	
181	B1227300	VALVE, REVERSING, RANCO #V2-310061-3GD (M1, M2, M3, M4)	
181	B1227302	VALVE, REVERSING, RANCO #V6-312081-1GD (M5)	
191	B1225017	SOLENOID, 24 VOLT COIL, REVERSING VALVE, RANCO # L30-12000-0GD	
201	B1219301	MUFFLER (1/2 X 1/2), PARKER # P54801-02 (M5)	
201	B1219300	MUFFLER (3/8 X 3/8), PARKER # 054801-01 (M1, M2, M3, M4)	
211	B1360719	SWITCH, LOW PRESSURE, T.I. # 20-PS025GA025E007C, RANCO # 070-116020-G01	
221	B9266812A	COMPRESSOR, 208/230-60-1, BRISTOL #H23B24SABCA (M3)	
221	B9266600A	COMPRESSOR, 208/230-60-1, BRISTOL #H25B17QABCA (M1, M2)	
221	B9266834A	COMPRESSOR, 208/230-60-1, BRISTOL #H29B22UABCA (M4)	
221	B9266843A	COMPRESSOR, 208/230-60-1, BRISTOL #H29B28UABCA (M5)	

Expanded Model Nomenclature

- M1 - CPLE18-1
- M2 - CPLE18-1A
- M3 - CPLE24-1
- M4 - CPLE24-1A
- M5 - CPLE30-1
- M6 - CPLE36-1
- M7 - CPLE42-1
- M8 - CPLE42-1
- M9 - CPLE48-3
- M10 - CPLE60-1
- M11 - CPLE60-3

Louvered Chassis & Control Box

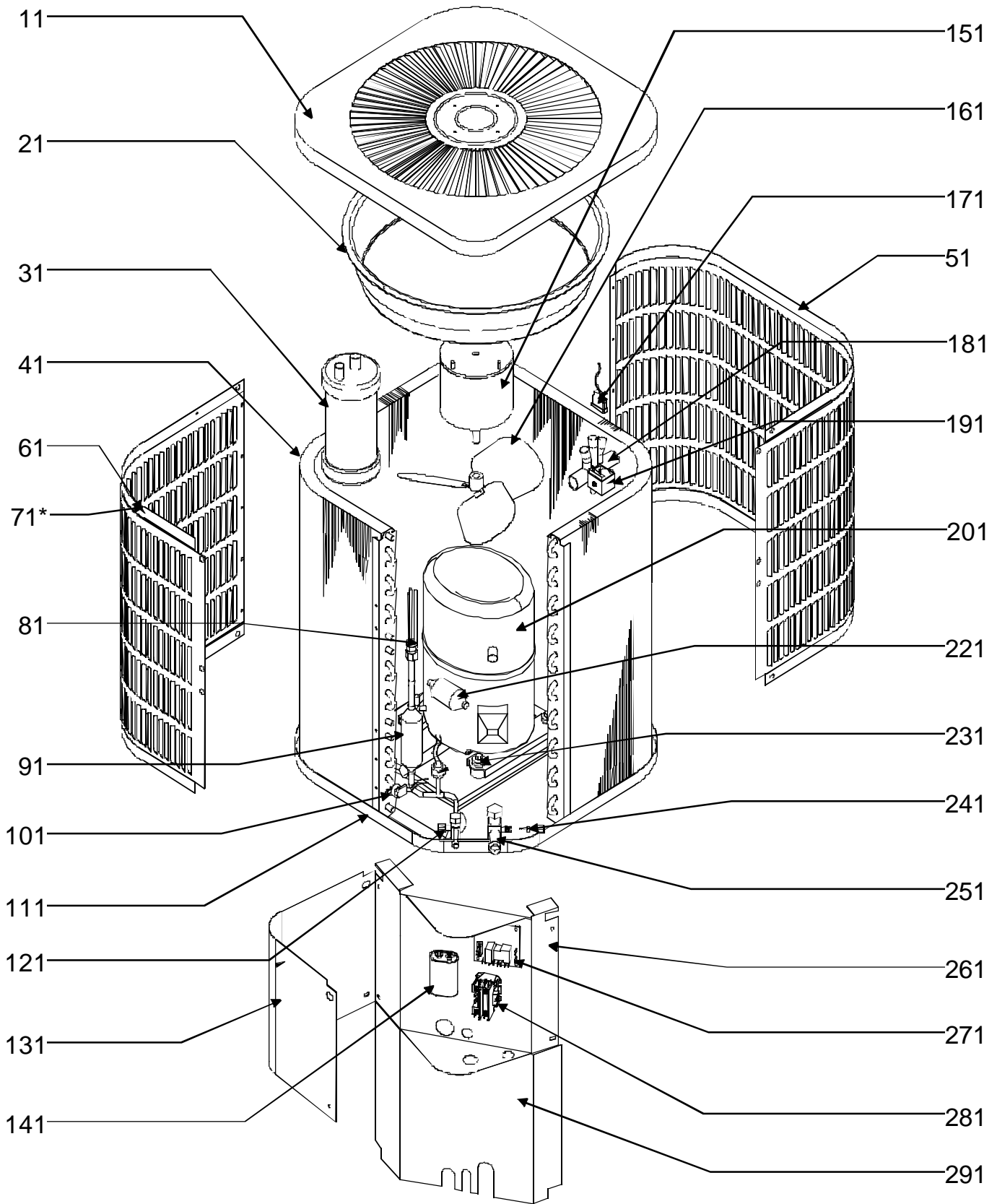

Louvered Chassis & Control Box

Ref. Part No:	Ref. Part No:	Description:	Ref. Part No:	Description:
<i>Image 1:</i>				
11	1779406P	PANEL, TOP (LOUVERED) (M6, M7, M8, M9, M10, M11)	201	B1219301 MUFFLER (1/2 X 1/2), PARKER # P54801-02 (M6, M7, M8, M9, M10, M11)
21	1787815	VENTURI, PLASTIC (M7, M8, M9, M10, M11)	211	B1360719 SWITCH, LOW PRESSURE, T.I. # 20-PS025GA025E007C, RANCO # 070-116020-G01
31	B1226206	ACCUMULATOR (3/4 O.D.) (M6)	221	B9266353 COMPRESSOR, 200/230-60-3, COPELAND #ZR57KC-TF5-230 (M11)
31	B1226207	ACCUMULATOR (7/8 O.D.) (M7, M8, M9, M10, M11)	221	B9266218A COMPRESSOR, 208/230-60-1, BRISTOL #H23A383ABCA (M7)
41	1260625NP	COIL, CONDENSER, (FORMED) (25" X 82") (M6)	221	B9266201A COMPRESSOR, 208/230-60-1, BRISTOL #H23A423ABCA (M8)
41	1260630NP	COIL, CONDENSER, (FORMED) (30" X 82") (M7)	221	B9266835A COMPRESSOR, 208/230-60-1, BRISTOL #H29B35UABCA (M6)
41	1260632NP	COIL, CONDENSER, (FORMED) (32.5" X 82") (M8, M9, M10, M11)	221	B9266355 COMPRESSOR, 208/230-60-1, COPELAND #ZR57KC-PFV-250 (M10)
51	1259560P	LOUVER PANEL H/PIN SIDE (M6)	221	B9266204A COMPRESSOR, 208/230-60-3, BRISTOL #H23A423DBLA (M9)
51	1259561P	LOUVER PANEL H/PIN SIDE (M7)	231	B1339530 GROMMET, COMPRESSOR (M6, M7, M8, M9)
51	1259569P	LOUVER PANEL H/PIN SIDE (M8, M9, M10, M11)	231	B1339533 GROMMET, COMPRESSOR (M10, M11)
61	1259564P	LOUVER PANEL RETURN SIDE (M6)	241	B1787000 CORE, VALVE (QTY 2)
61	1259565P	LOUVER PANEL RETURN SIDE (M7)	251	R1282566 VALVE, BASE, SUCTION LINE, 3/4" SWEAT X 3/4" SWEAT (M6)
61	1259572P	LOUVER PANEL RETURN SIDE (M8, M9, M10, M11)	251	R1282567 VALVE, BASE, SUCTION LINE, 7/8" SWEAT X 7/8" SWEAT (M7, M8, M9, M10, M11)
81	R2114465	FLOWRATER W/COPPER (M6)	261	1787623 BOX, CONTROL
81	R2114665	FLOWRATER W/COPPER (M7)	271	B1226008 DEFROST CONTROL W/RELAY
81	R2114674	FLOWRATER W/COPPER (M8, M9)	281	B1360321 CONTACTOR, 24 VOLT COIL, 125 LRA, 1 POLE, 25 AMP, (M6, M7)
81	R2114684	FLOWRATER W/COPPER (M10, M11)	281	B1360324 CONTACTOR, 24 VOLT COIL, 150 LRA, 1 POLE, 30 AMP (M8)
91	R1219204	DRIER, BI-FLOW. 3/8" x 3/8"	281	B1360315 CONTACTOR, 24 VOLT COIL, 150 LRA, 3 POLE, 25 AMP, (M9, M11)
91	B1370803	THERMOSTAT, DEFROST	281	B1360305 CONTACTOR, 24 VOLT COIL, 200 LRA, 2 POLE, 40 AMP, (M10)
111	1787212P	PAN, BOTTOM (LARGE) (M6, M7, M8, M9, M10, M11)	291	1787707P PANEL, ACCESS, (25.0") (M6)
121	B1282571	VALVE, BASE, LIQUID LINE, 3/8" SWEAT X 5/16" SWEAT	291	1787709P PANEL, ACCESS, (30.0") (M7)
131	1787624P	CONTROL BOX COVER	291	1787710P PANEL, ACCESS, (32.0") (M8, M9, M10, M11)
141	B94575400	CAPACITOR, DUAL-SECTION, 35 MFD, 5 MFD, 440 VAC (M7)	Expanded Model Nomenclature	
141	B94575600	CAPACITOR, DUAL-SECTION, 40 MFD, 5 MFD, 440 VAC (M8)	M1 - CPLE18-1 M2 - CPLE18-1A M3 - CPLE24-1 M4 - CPLE24-1A M5 - CPLE30-1 M6 - CPLE36-1 M7 - CPLE42-1 M8 - CPLE42-1 M9 - CPLE48-3 M10 - CPLE60-1 M11 - CPLE60-3	
141	B94577200	CAPACITOR, DUAL-SECTION, 45 MFD, 5 MFD, 370 VAC (M6)		
141	B94577500	CAPACITOR, DUAL-SECTION, 60 MFD, 5 MFD, 370 VAC (M10)		
141	B945650	CAPACITOR, RUN, 5 MFD, 370 VAC (M9, M11)		
151	B13400255	MOTOR CONDENSER FAN, 208/230-60-1, 1 SPEED PSC, 1075 RPM, 1/4HP (M7)		
151	B13400247	MOTOR, CONDENSER, FAN, 208/230-60-1, 1 SPEED, PSC, 1075 RPM, 1/4 HP (M6, M8, M9, M10, M11)		
161	B1086750	FAN, CONDENSER, 3 BLADE, 24° PITCH, 22" DIA., (M6, M7, M8, M9, M10, M11)		
171	B1225020	SOLENOID COIL CORD		
181	B1227310	VALVE, REVERSING, RANCO #V10-314081-1GD (M7, M8, M9, M10, M11)		
181	B1227302	VALVE, REVERSING, RANCO #V6-312081-1GD (M6)		
191	B1225017	SOLENOID, 24 VOLT COIL, REVERSING VALVE, RANCO # L30-12000-0GD		