



**HOME OWNER / INSTALLER
FOR YOUR SAFETY
THIS MANUAL MUST BE READ IN ITS
ENTIRETY BEFORE OPERATING HEATER**

**RCE-506A
SILENT SERVANT
CONVECTOR VENT-FREE SPACE HEATER**

Owner's Operation and Installation Manual

WARNING: IF THE INFORMATION IN THIS MANUAL IS NOT FOLLOWED EXACTLY, A FIRE OR EXPLOSION MAY RESULT CAUSING PROPERTY DAMAGE, PERSONAL INJURY OR LOSS OF LIFE.

DO NOT STORE OR USE GASOLINE OR OTHER FLAMMABLE VAPORS AND LIQUIDS IN THE VICINITY OF THIS OR ANY OTHER APPLIANCE.

WHAT TO DO IF YOU SMELL GAS

- DO NOT TRY TO LIGHT ANY APPLIANCE.
- DO NOT TOUCH ANY ELECTRICAL SWITCH; DO NOT USE ANY PHONE IN YOUR BUILDING.
- IMMEDIATELY CALL YOUR GAS SUPPLIER FROM A NEIGHBOR'S PHONE. FOLLOW THE GAS SUPPLIER'S INSTRUCTIONS.
- IF YOU CANNOT REACH YOUR GAS SUPPLIER, CALL THE FIRE DEPARTMENT.

INSTALLATION AND SERVICE MUST BE PERFORMED BY A QUALIFIED INSTALLER, SERVICE AGENCY OR THE GAS SUPPLIER.

INSTALLER: MUST LEAVE MANUAL WITH UNIT AFTER INSTALLATION.
OWNER: RETAIN THIS MANUAL SAFELY, FOR FUTURE REFERENCE.

Rinnai

WARNING

IMPROPER INSTALLATION, ADJUSTMENT, ALTERATION, SERVICE OR MAINTENANCE CAN CAUSE PROPERTY DAMAGE, PERSONAL INJURY OR LOSS OF LIFE. REFER TO THE OWNER'S INFORMATION MANUAL PROVIDED WITH THIS APPLIANCE. INSTALLATION AND SERVICE MUST BE PERFORMED BY A QUALIFIED INSTALLER, SERVICE AGENCY OR THE GAS SUPPLIER. FOR ASSISTANCE OR ADDITIONAL INFORMATION CONSULT A QUALIFIED INSTALLER, SERVICE AGENCY OR THE GAS SUPPLIER.

GENERAL INFORMATION



THIS SERIES IS DESIGN CERTIFIED BY THE AMERICAN GAS ASSOCIATION LABORATORIES AS A VENT FREE CIRCULATOR AND MUST BE INSTALLED ACCORDING TO THESE INSTRUCTIONS.

ANY ALTERATION OF THE ORIGINAL DESIGN INSTALLED OTHER THAN AS SHOWN IN THESE INSTRUCTIONS OR USED WITH A TYPE OF GAS NOT SHOWN ON THE RATING PLATE, IS THE RESPONSIBILITY OF THE PERSON AND COMPANY MAKING THE CHANGE.

TABLE OF CONTENTS

	Page
SPECIFICATIONS	1
SAFETY DEVICES	1
IMPORTANT POINTS	2
SAFETY POINTS	3
USAGE AND INSTALLATION MUSTS	5
INSTALLATION INSTRUCTIONS	6
OPERATING INSTRUCTION LABEL	9
ADDITIONAL CUSTOMER OPERATING INFORMATION	10
MAINTENANCE / SERVICE	13
TROUBLE SHOOTING CHART	14
SCHEMATIC DISASSEMBLY	16
LIMITED WARRANTY	23

SPECIFICATIONS

Model	Input/Rating BTU/H HIGH	Input Rating BTU/H LOW	THERMOSTAT	Weight in pounds	Dimension in inches
RCE-506A-N	20,000	5,000	YES	22.75	Height: 17 1/2 Width: 22 1/2 Depth: 7 3/4
RCE-506A-P	19,000	5,500	YES		

"-N" Models are for Natural Gas. (Inlet Pressure within 5.3"—10.5" W.C.)

"-N" Models manifold pressure: 3.9" W.C.

"-P" Models are for L.P. Gas. (Inlet Pressure within 8.2" —13" W.C.)

"-P" Models manifold pressure: 7.5" W.C.

Gas connection pipe size 1/2" N.P.T. all models.

SAFETY DEVICES

■ Overheat Switch

When the heater gets too hot during operation (for example when the filters or air outlet louvers are blocked) this device turns the gas off automatically. Remove cause of overheat (clean filters) allow heater to cool, then re-ignite.

■ Fuse

The electrical circuits are protected by a fuse. When the fuse blows, the heaters will not operate at all. The fuse must be replaced by an authorized person.

■ Flame Failure Device

This device automatically cuts off the gas supply to the heater in the event of a gas failure. To restore the gas supply to the heater, turn it off, then follow the ignition procedure.

■ Oxygen Depletion Safety Device

If the oxygen level in the room drops below a pre-set limit, this device cuts the gas supply to the heater. If the oxygen depletion device operates, turn the heater off, ventilate the room, then follow the ignition procedure to re-light. Heater will not re-light until room is fully ventilated.

■ Tilt Switch

If the heater is knocked over, the tilt switch will cut the gas supply. The fan keeps running. To restore the gas supply, stand the heater upright, turn it off then follow the ignition procedure. The tilt switch may also operate if the heater is jolted or picked up while in operation.

■ Power Failure

In the event of a power failure or power cut, the gas valves will automatically close. After the power is re-instated the appliance must be restarted.

IMPORTANT POINTS

UNPACK HEATER:

Check for damage. (DO NOT INSTALL DAMAGED HEATER.) If heater is damaged, contact your supplier for advice. Before installing a heater, check the label for the correct gas type (see label on side of heater). Refer to local gas authority for confirmation of gas type if you are in doubt.

INCLUDED IN CARTON:

Customers Operating Information / Manual Gas Valve

IMPORTANT

1. The appliance must be installed in accordance with state and local codes.
2. For information on gas rate, see data plate on the appliance.
3. When using this appliance, ensure that the room is correctly ventilated. Check the local gas authority for information on ventilation requirements.
4. The heater must not be installed where curtains or other combustible materials could come into contact with it. In some cases curtains may need restraining. It must also be 2" (50mm) clear of walls.
5. This appliance is not designed to be built in.
6. If you move, check the gas type in the area where you are moving to. The local gas authority will be able to advise on local regulations.
7. This heater discharges a large volume of warm air at low level to provide even heat distribution. If the air in the room contains cooking vapor or cigarette smoke, and the heater is used on a carpet, the surface of the carpet may become discolored.
In addition, some nylon carpets contain dyes which may be affected by the warm air flow. Some soft vinyl surfaces are also subject to distortion, or discoloration by warm air. To prevent discoloration of carpets etc., a mat should be placed under the appliance, extending about 30" (750mm) in front of it.

SAFETY POINTS

Do not install this heater in areas where spray painting or plating is taking place, or in places such as hair dressers, where there may be a lot of fluff and dust, and where aerosols are used. May create strong odors and irritate eyes and sinuses.

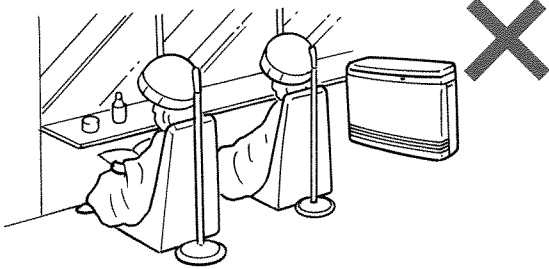

Do not move the heater while it is turned on.

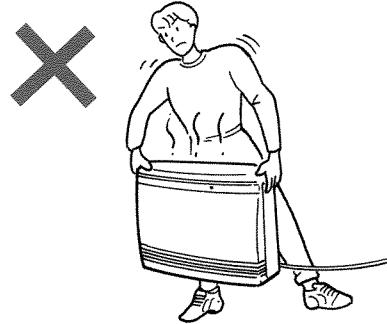

Do not spray aerosols near this heater while it is in use. Many aerosols contain butane gas and can be a fire hazard if used near this heater when it is in use. USE of aerosols, paint, polishes etc., while this heater is in use will cause unpleasant smells.

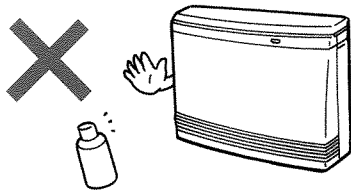

Turn off heater when not in use and when away for long periods of time.

IGNITION BUTTON

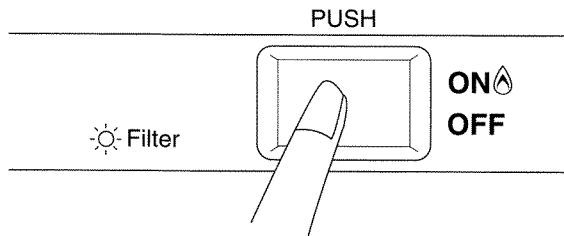

Do not allow children or elderly persons to sleep in the warm air discharge from the heater.

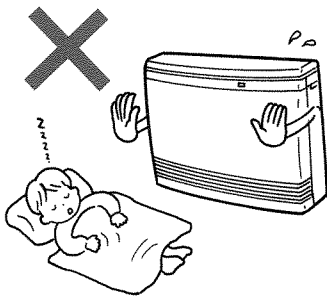

Do not sit on this heater.

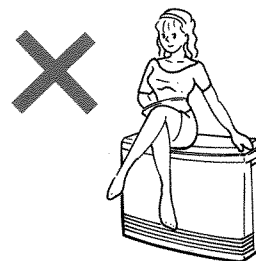

SAFETY POINTS

Do not place wet articles on this heater, the water may drip into the electrical parts.

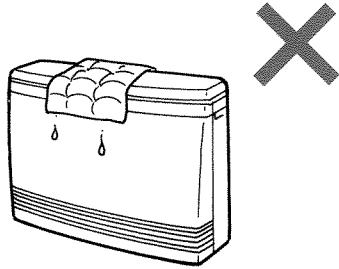

Do not allow children to put articles in the louvers. Supervise children playing near this heater.

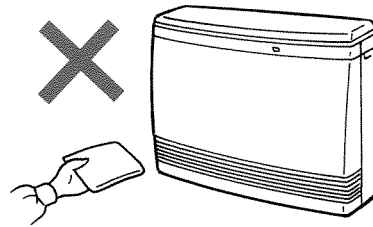

Do not turn the heater off by unplugging it from the wall, or while the fan is cooling the heater off. (This heater is not suitable for use with a plug in type timer.)

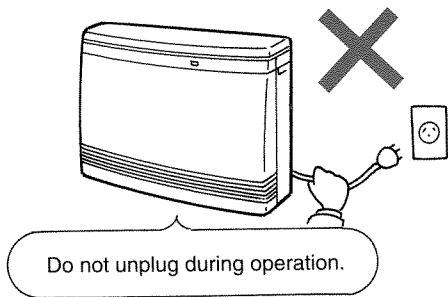

Ventilate the room when this heater is in use. Correct, fixed ventilation is usually sufficient, consult your local gas authority for local regulations.

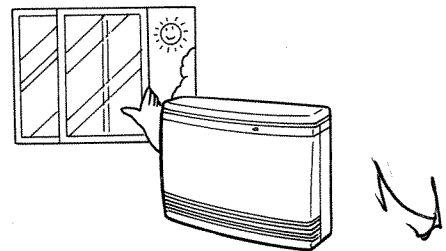

Keep away from flammable materials. Combustible materials must not be placed where the heater could ignite them. Do not place articles in front of the hot air discharge.

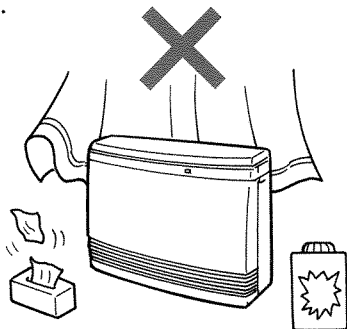

Do not place containers of liquid on top of the heater. Water in the heater can cause extensive damage.

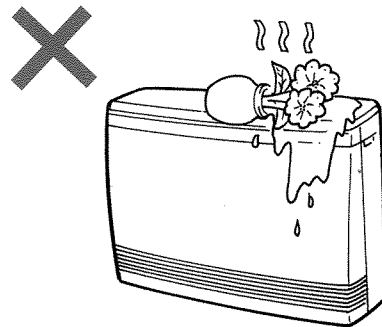

USAGE AND INSTALLATION MUSTS

1. Read these rules and the instructions carefully. Check all local codes. Failure to follow these could cause a malfunction of the heater resulting in death, serious bodily injury and/or property damage.
2. This heater is designed for use only with one type of gas, either L.P.G. or Natural Gas. Make sure that the type of gas to be supplied to this unit matches that shown on the rating plate on the heater.
3. **WARNING:** Any change to this heater or its controls can be dangerous.
4. If a gas leak is suspected, turn heater off, turn gas supply valve off at regulator or appliance connector valve. Open windows to ventilate area immediately and contact your dealer or gas company.
5. Installation and repair should be done by a qualified service person. Heater should be inspected before use and at least annually by a professional service person. More frequent cleaning may be required due to excessive lint from carpeting, bedding material, etc. It is imperative that control compartment, burners and circulating air passageways be kept clean.
6. **An unvented room heater having an input rating of more than 10,000 BTU's per hour shall not be installed in a bedroom or bathroom or where state or local codes do not allow.**
An unvented room heater having an input rating of more than 6,000 BTU's per hour shall not be installed in a bathroom or where state or local codes do not allow.
7. Keep area near the heater clear and free from combustible materials, gasoline and other flammable vapors and liquids.
8. Due to its high temperature, the heater should be located out of traffic and away from furniture and draperies.
9. Do not place clothing or flammable material on or near the heater.
10. Any safety panel or guard removed for servicing must be replaced prior to operating the heater.
11. A fresh air opening for combustion and ventilation air must be provided into the room where the heater is installed. The opening must have at least one square inch of free air opening per 1,000 BTU/H of gas consumption for the total input rating of all gas equipment in the enclosure.
12. An unvented gas heater will increase the amount of humidity in the room.
13. This heater is intended for space heating purposes only. Do not use for other purposes such as drying clothes or baking paints.
14. Do not touch the outlet area while the heater is in use. To avoid burns, do not move the heater during use and avoid touching the heater just after turning off.

15. Children and adults should be alerted to the hazard of high surface temperatures and should stay away to avoid burns or clothing ignition.

16. Young children should be carefully supervised when they are in the same room with the heater.

17. LPG containers must not be installed indoors.

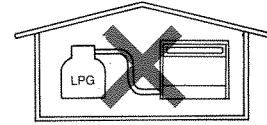

18. Do not install in a windy area. Such as facing a window or a door leading to the outside.

19. Do not use this room heater if any part has been under water. Immediately call a qualified service technician to inspect the room heater and to replace any part of the control system and any gas control which has been under water.

20. Carpet lint may pass through the heater, discolor, and be deposited into the room.

21. This unit discharges a large volume of warm air at a low level to provide even heat distribution. If the air in the room contains cooking vapors, cigarette smoke, and if used on carpet, the surface in front of unit is subject to discoloration. Some carpets contain dyes which were effected by warm air flow and they will discolor. To aid in prevention of discoloration, place a mat under the unit to extend to the front 30".

INSTALLATION INSTRUCTIONS

NOTICE BEFORE INSTALLATION

The heater must be installed by a qualified service person according to this installation instruction.

Check your local building codes for the proper method of installation. In the absence of local codes, this heater installation must conform with American National Standard (National Fuel Gas Code) known as NFPA 54 and ANSI Z223.1 – 1992 or latest edition.

Available from the American National Standards Institute, Inc.,
1430 Broadway, New York, NY 10018, or from the National Fire
Protection Association, Batterymarch Park, Quincy, MA 02269.

All correspondence should refer to Model No., Serial No., and type of gas.

WARNING: Electrical Grounding Instructions

This appliance is equipped with a three-prong (grounding) plug for your protection against shock hazard and should be plugged directly into a properly grounded three-prong receptacle.

LOCATION AND CLEARANCES

1. The minimum clearances from the combustible materials are as follows:

- 2 inches from top
- 2 inches from back
- 2 inches from side
- 30 inches from front
- 0 inches from bottom

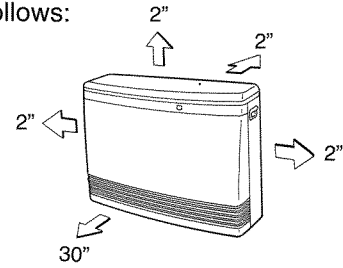

2. This heater may be installed on combustible flooring. When the heater is installed directly on carpeting, tile or other combustible material other than wood flooring, the heater shall be installed on a metal or wood panel extending the full width and depth of the heater.
3. Adequate clearances for accessibility for purposes of servicing and proper operation be provided.
4. Adequate clearances around air openings be provided.
5. Do not install in bedrooms/sleeping quarters or bathrooms where state and local codes do not allow.
6. Right and left sides are determined when facing the front.
7. Do not install in areas where curtains, drapes, clothing, or other moving flammables are within 12 inches of this unit.
8. This unit is not designed to mount directly to a wall.
9. Make certain of adequate combustion and ventilation air.
10. Do not oversize the heater to the room.

GAS CONNECTION

1. The gas supply line shall be gas-tight, size and so installed as to provide a supply of gas sufficient to meet the maximum demand of the heater without loss of pressure.
2. A shut off valve (or appliance connector valve) should be installed in the upstream of the gas line to permit servicing.
3. Flexible pipe and any appliance connector valve used for gas piping shall be types approved by nationally recognized agencies.

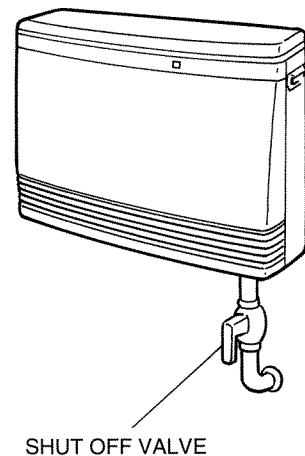

4. Any compound used on the threaded joint of gas piping shall be a type which resists the action of liquefied petroleum gas.
5. Supplied gas pressure must be within the limits shown in the specifications.
6. After completion of gas pipe connections, all joints including the heater must be checked for gas-tightness by means of leak detector solution, soap and water, or an equivalent nonflammable solution, as applicable.

CAUTION: Since some leak test solutions, including soap and water, may cause corrosion or stress cracking, the piping shall be rinsed with water after testing, unless it has been determined that the leak test solution is noncorrosive.

7. The appliance and its individual shut off valve must be disconnected from the gas supply piping system during any pressure testing of that system at test pressures in excess 1/2 psig. The appliance must be isolated from the gas supply piping system by closing its individual manual shut off valve during any pressure testing of the gas supply system at test pressures equal to or less than 1/2 psig.
8. A valve supplied must be installed on back of unit at time of installation. See page 8 and Figure #2. This is for compliance to ANSI standard Z21.11.2. Valve is packaged with unit.

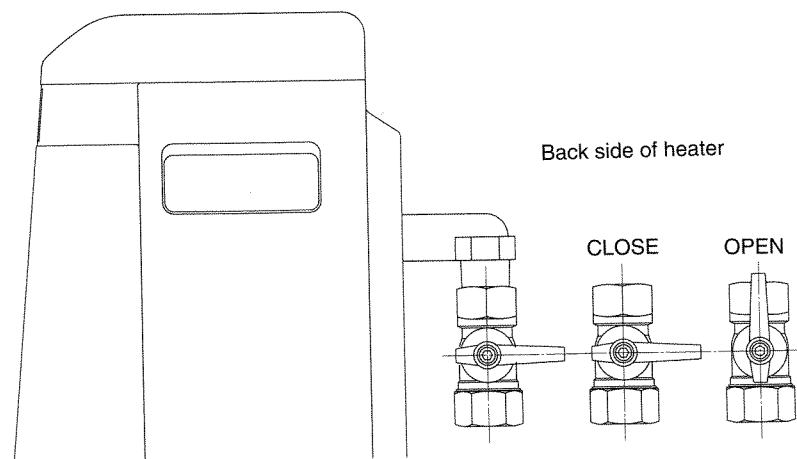

FIGURE 2

OPERATING INSTRUCTION LABEL CONVECTOR RCE-506A

FOR YOUR SAFETY READ BEFORE OPERATING

WARNING: If you do not follow these instructions exactly, a fire or explosion may result causing property damage, personal injury or loss of life.

- A. This appliance does not have a pilot. It is equipped with an ignition device which automatically lights the burner. Do not try to light the burner by hand.
- B. BEFORE OPERATING smell all around the appliance area for gas. Be sure to smell next to the floor because some gas is heavier than air and will settle on the floor.
- WHAT TO DO IF YOU SMELL GAS.**
- Do not try to light any appliance.
 - Do not touch any electric switch; do not use any phone in your building.
 - Immediately call your gas supplier from a neighbor's phone. Follow the gas supplier's instructions.
 - If you cannot reach your gas supplier, call the fire department.
- C. Use only your finger to push with. Never use tools. If the button will not reactivate by touch, don't try to repair it, call a qualified service technician. Force or attempted repair may result in a fire or explosion.
- D. Do not use this appliance if any part has been under water. Immediately call a qualified service technician to inspect the appliance and to replace any part of the control system and any gas control which has been under water.

OPERATING INSTRUCTIONS

- STOP! Read the safety information above on this label. This appliance is equipped with an ignition device which automatically lights the burner. Do not try to light the burner by hand.
1. Turn off all electric power to the appliance via the ON/OFF button on the control panel. Locate manual gas valve to be found on back side of heater.
 2. Turn Manual valve clockwise  to the full OFF position.
 3. Wait five (5) minutes to clear out any gas. Then smell for gas, including near the floor. If you then smell gas,
4. Turn Manual gas valve to the full ON position.
 5. Turn on all electric power to the appliance.
 6. Set the thermostat to desired setting.
 7. Burner is lit when ON/OFF switch glows red.
 8. If ON/OFF switch is flashing red, burner has not been lit.
 9. If the appliance will not operate, follow the instruction "TO turn off gas to appliance" and call your service technician or gas supplier.

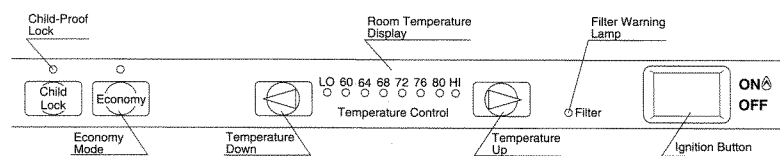
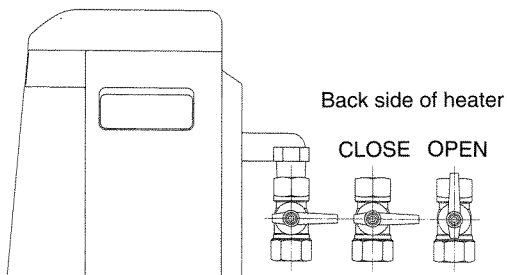

TO TURN OFF GAS TO APPLIANCE

1. Turn off electric power to the appliance using the ON/OFF switch located on the control panel.
2. Turn manual valve clockwise to the full OFF position.

NOTE: The fan will continue to operate until the appliance is cool, do not turn the appliance off by unplugging it from the wall.

Keep burner and control compartment clean. See installation and operating instructions accompanying heater.

ADDITIONAL CUSTOMER OPERATING INFORMATION

INSTALLATION

Check room size and ventilation. Do not oversize.
Improper sizing may cause nuisance lock out.

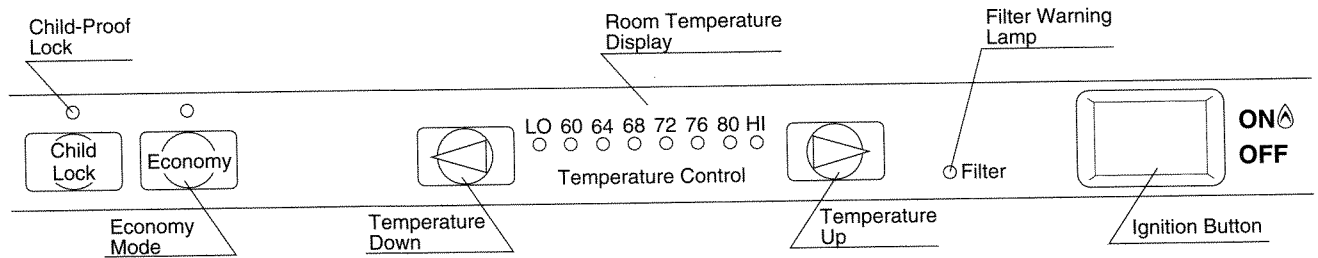

IGNITION

Make certain the heater is connected into both the gas and the electric power.
Depress the ignition button slowly and firmly.

IGNITION BUTTON

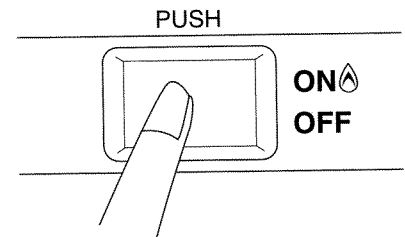

When you release the ignition button the 'Temperature Level' lamps will illuminate, the spark will ignite the main burner and the convection fan will begin to run. If the heater does not ignite within 15 seconds the spark will stop and the 'Temperature Level' lamps will flash. Turn off unit and repeat ignition operation.

TEMPERATURE LEVEL

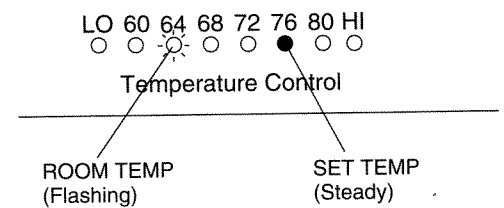

This heater has an automatic ignition system, when the main burner has lit, the ignition button will glow red, and the spark will stop. There may be a smell of burning dust or oil the first time the heater is lit or when the heater has been out of operation for a long time, this is normal. You may need to repeat the ignition operation the first time the heater is plugged in, due to air in the gas line.

COMBUSTION INDICATOR

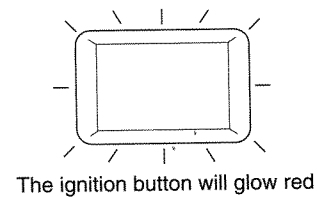

TEMPERATURE CONTROL

The thermostat automatically modulates the burner and the fan to maintain the room temperature which you have selected.

To change the room temperature, simply adjust the temperature control buttons until the desired setting is indicated. The heater will run on high for 1 to 2 minutes after ignition no matter where the temperature control is set.

The temperature range from LO to HI is about 54°F (12°C) to 97°F (36°C). Temperature control may be affected by the location of the heater.

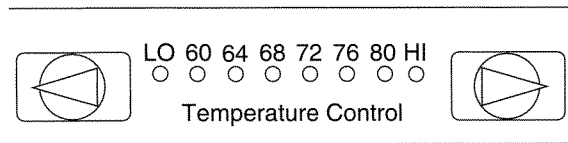

ROOM TEMPERATURE DISPLAY

Temperature is indicated by the L.E.D. display on the control panel. The room temperature is indicated by the flashing L.E.D., and the set temperature by the steady L.E.D. When the set temperature is reached, the flashing L.E.D. disappears and the temperature is indicated by the steady L.E.D. You will notice the fan speed changing as the heater modulates to match the room temperature.

TEMPERATURE LEVEL

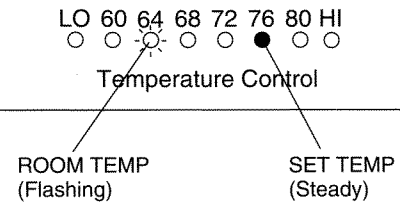

TO TURN UNIT OFF

Depress ignition button again.
The switch will return to the off position.
Do not turn off by unplugging at the power outlet.
Convection fan continues to run until heater is cool.
The convection fan may start again after a few minutes to remove any residual heat.

IGNITION BUTTON

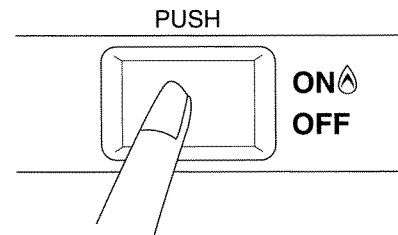

ECONOMY BUTTON

To select 'Economy Mode', push the 'Economy' button, the green lamp will glow. 30 minutes after the room temperature reaches the preset temperature (set with the thermostat), the 'Economy Mode', if set, reduces the temperature by 2°F, after another 30 minutes it reduces the temperature by a further 2°F, this is an energy saving feature. When the heater is running in lowest position on the thermostat, the 'Economy Mode' does not operate. It does not operate if the heater is under capacity for the room size.

FILTER LAMP

If the filter lamp glows during operation, check both air filters for dust. If there is dust present, clean filter. See section on care of heater. Turn heater off before cleaning filters.

ECONOMY

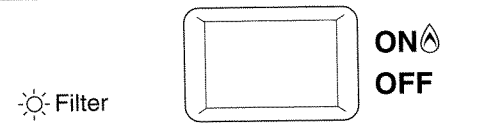
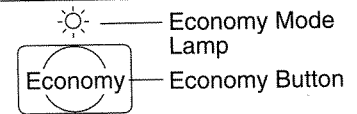

MAINTENANCE / SERVICE

MAINTENANCE SUGGESTIONS

This heater has been designed and constructed for a long performance life when installed and operated properly under normal conditions. Regular inspections, as outlined in this section, are strongly recommended as means of keeping your heater operating efficiently and safely throughout the season. Access to internal parts is from the front of the heater.

1. Cleaning

Clean both air filters at least once a week. Do not wait for filter warning lamp to come on before cleaning filters. Do not use the heater with the filter warning lamp on, this may cause it to overheat. Dusty filters reduce the air flow through the heater, as well as, reducing the heater's effectiveness. Clean filters with air pressure or vacuum cleaner.

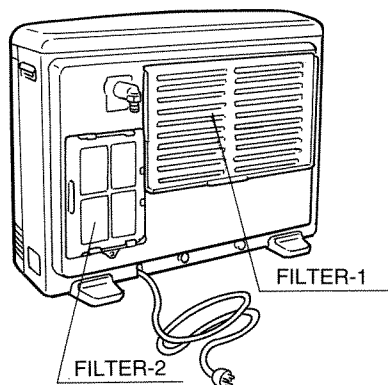

Heater must be cleaned annually. Keep heater clear of dust and debris especially in and around the ODS burner. Cleaning procedures of heater are as follows;

- 1) Turn heater off. Unplug electric cord and allow to cool for one hour.
- 2) Remove the front panel by removing two screws located at the right side corner of the front panel and pull it forward at its right edge.
- 3) Use pressurized air to remove dust from around ODS burner and electrical compartment.
- 4) All outside parts of the heater can be cleaned using soap and water on a soft damp cloth.

DO NOT DAMAGE OR DISTORT ANY PARTS OF HEATER.

DO NOT USE WET CLOTH OR SPRAY CLEANERS ON BURNER.

UNIT SHOULD BE CHECKED AND CLEANED ANNUALLY BY A PROFESSIONAL.

TROUBLE SHOOTING

STEP 1:

- 1) Be sure the heater is properly installed. See Section 2. INSTALLATION.
- 2) Make sure gas valve on L.P. Gas bottle or gas supply line is ON and gas pressure is available.
- 3) Make a careful visual inspection of all electrical connection and wiring.

- 4) **CAUTION:** Label all wires prior to disconnecting when servicing controls. Wire errors can cause improper and dangerous operation. Verify proper operation after servicing.
- 5) If any of the original wire as supplied with the appliance must be replaced, it must be replaced with a wire of at least a 194°F temperature rating.
- 6) **WARNING:** Electrical Grounding Instructions
This appliance is equipped with a three-prong (grounding) plug for your protection against shock hazard and should be plugged directly into a properly grounded three-prong receptacle. **DO NOT CUT OR REMOVE THE GROUNDING PRONG FROM THIS PLUG!**

STEP 2:

If the trouble persists after checking step 1, please check the cause of trouble in the following trouble shooting chart and correct it by following the procedures shown below.

TROUBLE SHOOTING CHART

Please note: General cleaning, maintenance and wear and tear are not necessarily covered under the warranty. Calls of this nature may be chargeable.

PROBLEM CAUSE	OPERATION LAMP DOES NOT GLOW	BURNER DOES NOT IGNITE (NO COMBUSTION LAMP)	BURNER GOES OUT WHEN YOU RELEASE IGNITION BUTTON	YELLOW FLAME	ROOM TEMP DOES NOT INCREASE	BURNER GOES OUT	FILTER WARNING LAMP GLOWS	REMEDY
NOT PLUGGED IN	●	●						PLUG THE HEATER IN
AIR IN THE HOSE		●						REPEAT IGNITION PROCEDURE
WRONG GAS TYPE		●						SERVICE CALL
OPERATION INCORRECT	●	●	●					SEE THE CUSTOMER'S OPERATING INSTRUCTIONS
LOUVER IS BLOCKED						●	●	REMOVE OBSTRUCTION
DUST ON THE AIR FILTERS					●	●	●	CLEAN THE AIR FILTERS (WEEKLY)
DUST INSIDE THE HEATER				●		●		SERVICE CALL
ROOM TOO LARGE					●			CHECK WITH RETAILER
GAS TURNED OFF AT METER	●	●						

SERVICE: If you are unsure about the way your heater is operating, contact Rinnai America Corporation, or your local agent.

WIRING DIAGRAM

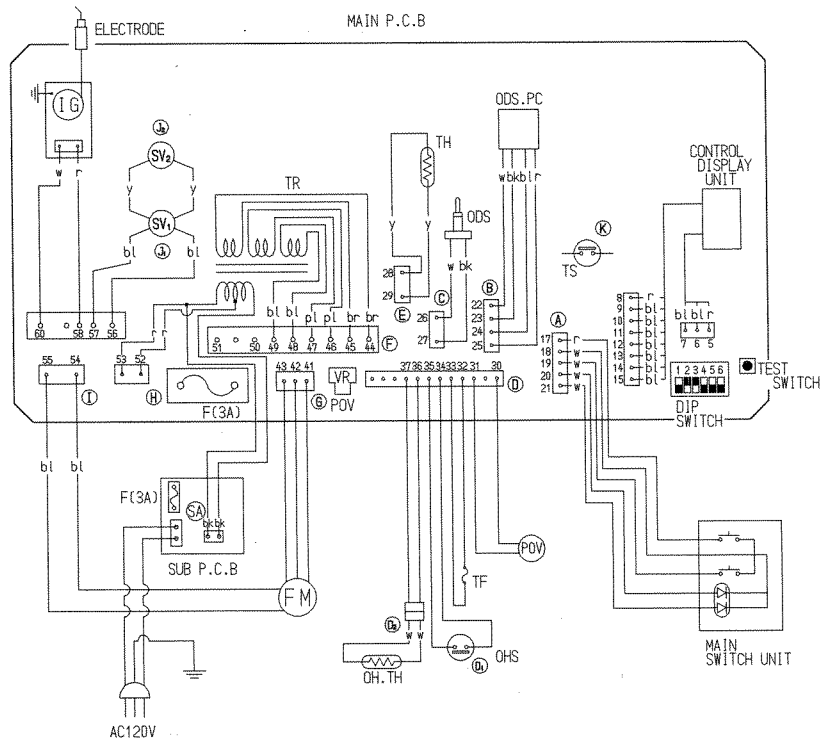

BLOCK DIAGRAM

CODE	COLOR
bk	black
bl	blue
br	brown
pl	purple
r	red
w	white

MARK	PART NAME	MARK	PART NAME
TH	THERMISTOR	OH,TH	OVER HEAT THERMISTOR
TF	THERMAL FUSE	OHS	OVER HEAT SWITCH
F	FUSE	FM	FAN MOTOR
POV	MODULATING SOLENOID VALVE	IG	IGNITER
TR	TRANSFORMER	SV1-2	MAIN SOLENOID VALVE 1-2
TS	TIP OVER SWITCH	SA	SURGE ABSORBER
ODS	OXYGEN DEPLETION SENSOR		

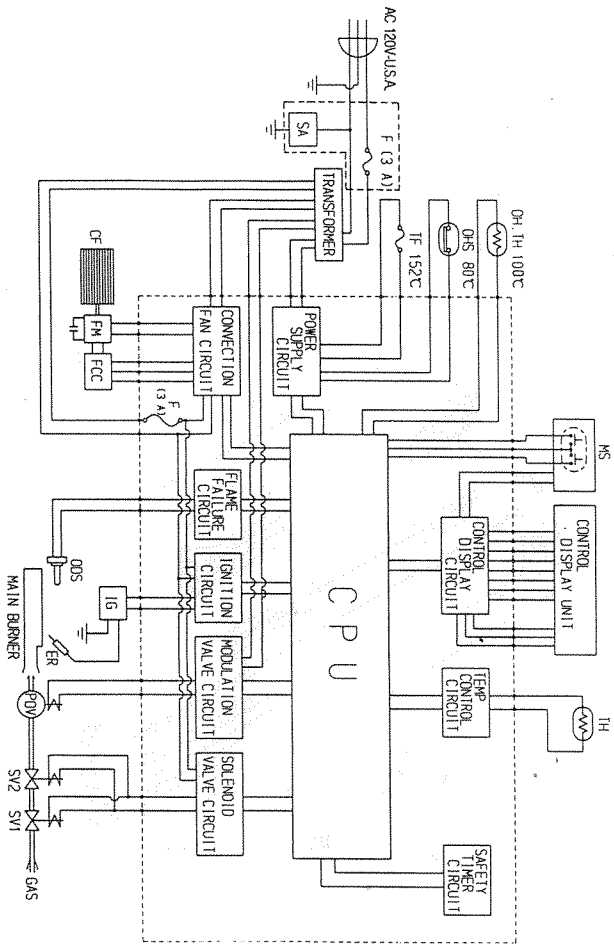

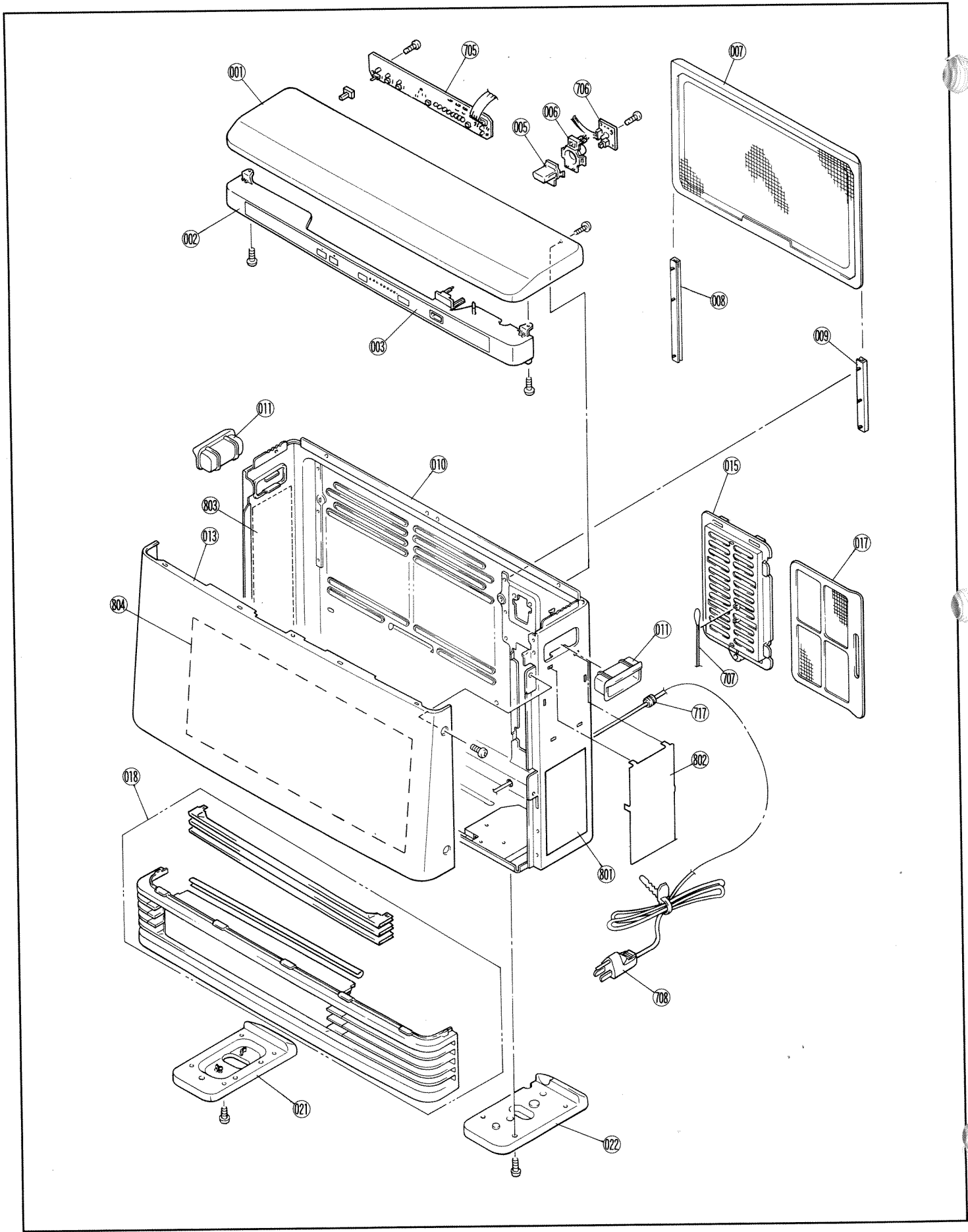

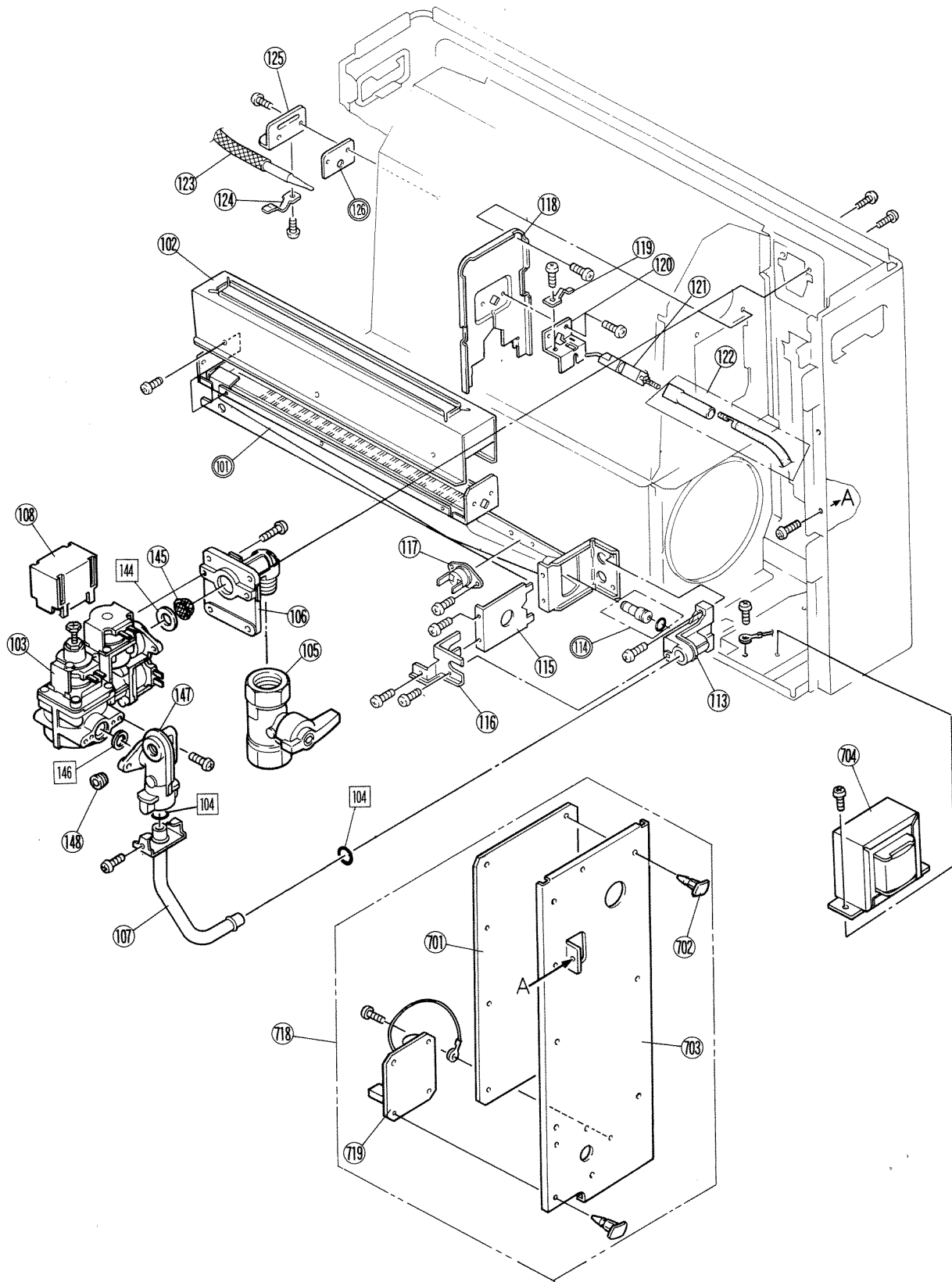

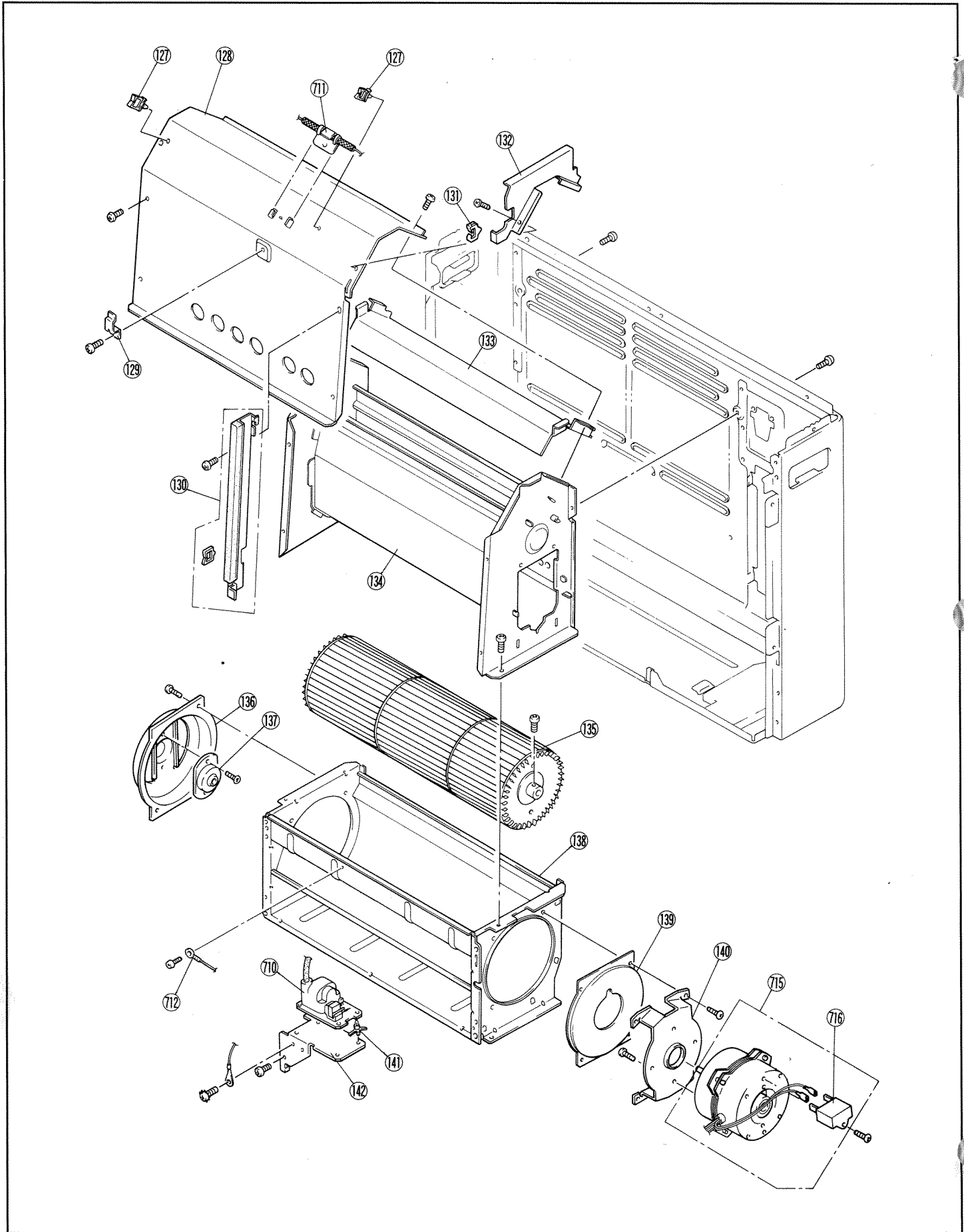

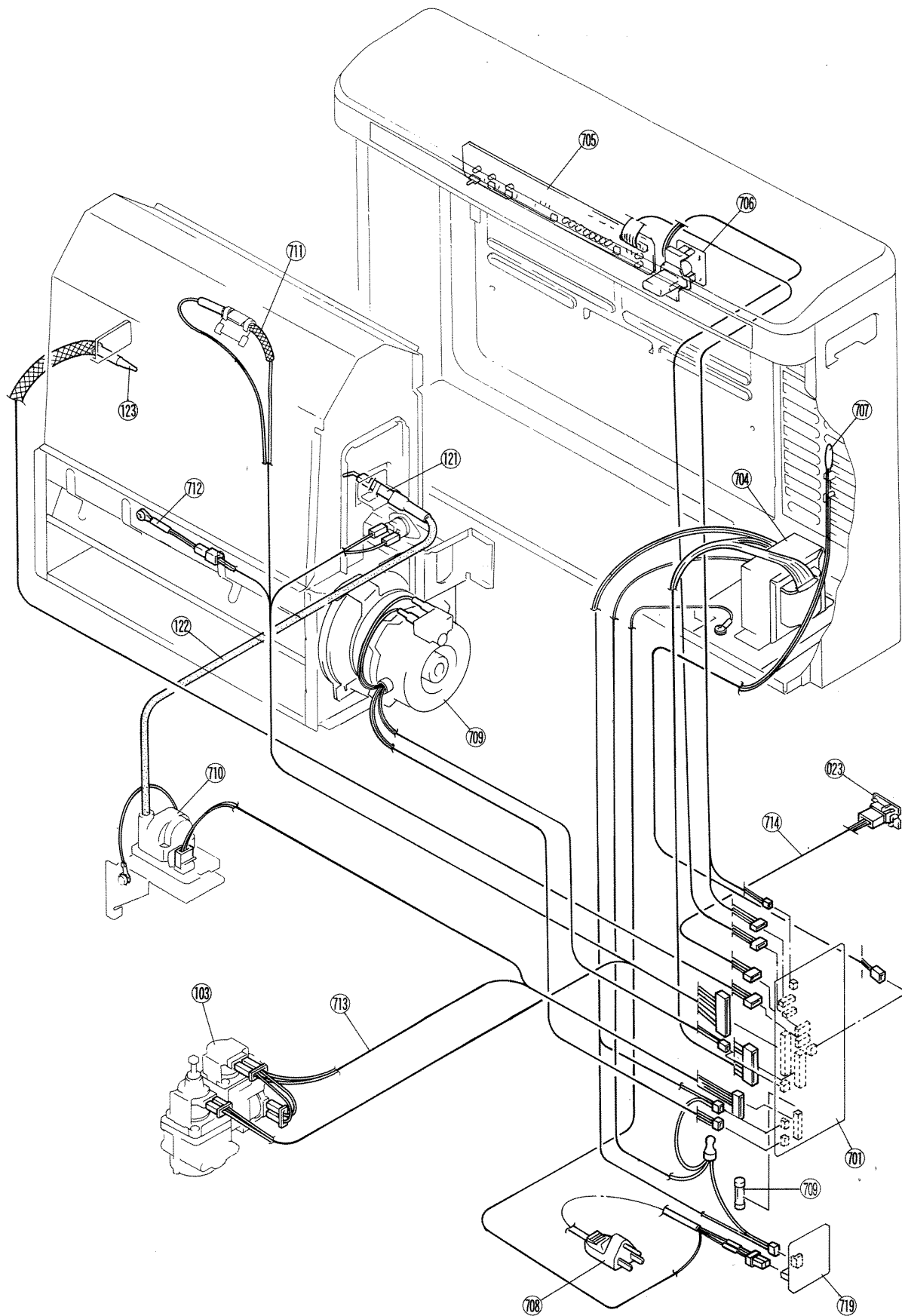

No.	PART NAME	PART No.	QTY.	REMARKS
001	TOP PLATE	RC-504-20-4	1	
002	OPERATION PLATE	RC-506-36-1	1	
003	CONTROL PANEL	RC-506-1052	1	
005	OPERATION SWITCH	RC-506-37	1	
006	REFLECTOR	RC-215-76	1	
007	AIR FILTER ASS'Y	RC-409-21-2	1	
008	AIR FILTER SUPPORTER	RC-209-15-2	1	
009	FILTER SUPPORTER B	RC-504-33-2	1	
010	REAR PANEL ASS'Y	RC-506-1009	1	
011	HANDLE	650P-69-12	2	
012				
013	FRONT PANEL	RC-504-23-4	1	
014				
015	RESIN FILTER CASE	RC-504-52-1-1	1	
017	RESIN FILTER	RC-504-54-2	1	
018	LOUVER ASS'Y	RC-506-21-1	1	
021	LEG LEFT	RC-501-45-6	1	
022	LEG RIGHT	RC-409-26-6	1	
023	TC CHECK HOLDER	RC-417-56-2-1	1	
101	BURNER ASS'Y (NG)	RC-504-180	1	
101	BURNER ASS'Y (LPG)	RC-504-185-2	1	
102	SECONDARY AIR COVER (LPG)	RC-408-14-2	1	
102	SECONDARY AIR COVER (NG)	RC-408-14-1	1	
103	GAS CONROL ASS'Y	C36L-1	1	
104	O RING	C14K2-5	2	
105	MANUAL VALVE ASS'Y	BRR37-244	1	
106	GAS INLET FLANGE	431F-1110-2	1	
107	CONNITION PIPE ASS'Y	RC-506-1008	1	
108	VALVE COVER	RC-506-1004	1	

No.	PART NAME	PART No.	QTY.	REMARKS
111	O RING	M10B-13-4	1	
113	INJECTOR HOLDER	RC-208-22	1	
114	INJECTOR	RC-208-11	1	-1-1.40(LPG) -2-2.10(NG)
115	DAMPER	RC-208-23	1	-19(NG) -25(LPG)
116	CONNECTION PIPE FIXER	RC-208-21	1	
117	OVER HEAT SWITCH	ES-01169	1	176°F OFF
118	BURNER LID	RC-208-37	1	
119	ELECTRODE BRACKET B	3120B-2213	1	
120	ELECTRODE BRACKET	RC-231-32	1	
121	ELECTRODE	RC-223-55	1	
122	HIGH TENSION CORD	1001F-1667-2	1	
123	THERMOCOUPLE TOTAL ASS'Y	RC-231-35-2	1	
124	THERMOCOUPLE FIXER	RC-210-89	1	
125	THERMOCOUPLE BRACKET	RC-208-25 (NG)	1	
125	THERMOCOUPLE BRACKET	RC-208-25-3 (LPG)	1	
126	TC SPACER B	RC-208-64-2	1	LPG ONLY
126	TC SPACER C	RC-208-64-3	1	LPG ONLY
127	CLAMP	CP-90203-1	2	
128	COMBUSTION CHAMBER COVER	RC-504-16-2	1	
129	OPERATION PANEL BRACKET	RC-504-67	1	
130	PARTITION BOARD ASS'Y	RC-504-43	1	
131	EDGE HOLDER	CP-90207	1	
132	TOP PARTITION BOARD	RC-506-25	1	
133	SEPARATION BOARD	RC-504-15	1	
134	COMBUSTION CHAMBER ASS'Y	RC-504-80	1	
135	CONVECTION FAN	RC-501-68	1	
136	BEARING BRACKET	RC-504-32	1	
137	BEARING	RC-223-74	1	
138	CASING ASS'Y	RC-501-67-2	1	
139	MOTOR COVER	RC-501-73	1	
140	MOTOR BRACKET	RC-332-34	1	
141	CIRCUIT BOARD SPACER	CP-90205-3	1	
142	IGNITER BRACKET	RC-209-83	1	
144	PACKING	C311-7	1	
145	FILTER	RCK-6808	1	
146	O RING	M10B-13-14	1	
147	OUTLET D	RC-209-98-4	1	
148	BLIND SCREW	AU39-965	1	

